

# Borg Warner Velvet Drive 70C, 71C, 72C, 73C



AUTOMATIC CHOICE



THE AUTOMATIC TRANSMISSION PARTS WAREHOUSE

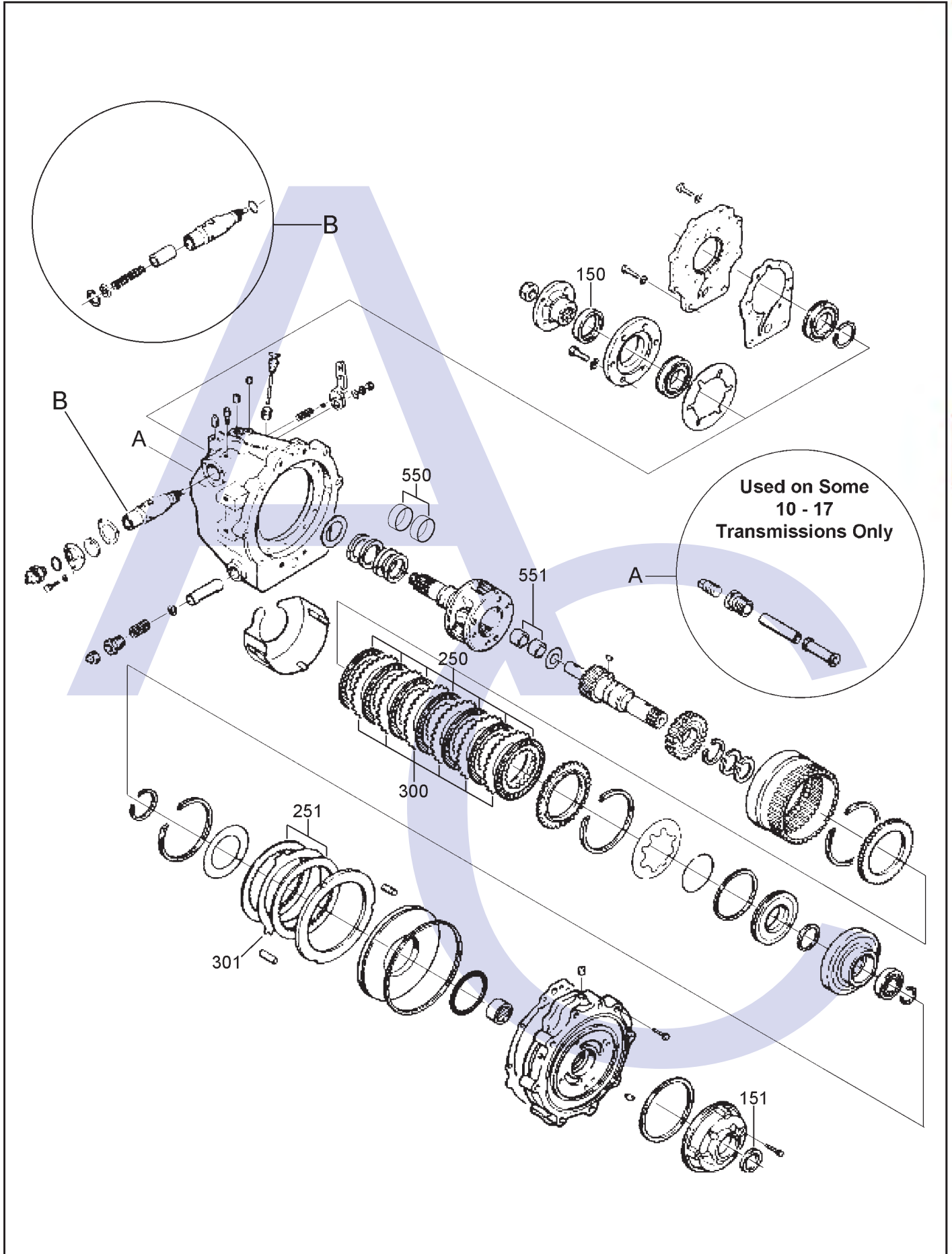

# Borg Warner Velvet Drive 70C, 71C, 72C, 73C



AUTOMATIC CHOICE



THE AUTOMATIC TRANSMISSION PARTS WAREHOUSE

ILL NO.	DESCRIPTION	YEARS	QTY	PART NO
<b>KITS</b>				
Kit	Master Overhaul (71C/72C)..... All		1	MARINE.MOHK01
Kit	Overhaul (70C, 71C, 72C) ..... All		1	MARINE.K01
Kit	Overhaul (71C, 72C Transtec)..... All		1	MARINE.K02
Kit	Overhaul (73C)..... All		1	MARINE.OHK02
<b>GASKETS</b>				
<b>RUBBER COMPONENTS</b>				
<b>METAL CLAD SEALS</b>				
150	Seal, Rear (1:1 Ratio 68mm OD)..... All		1	MARINE.MCS02
151	Seal, Pump (52mm OD)..... All		1	MARINE.MCS01
NI	Seal, Reduction Unit ..... All		1	MARINE.MCS03
<b>MOULDED PISTONS</b>				
<b>SEALING RINGS</b>				
<b>FRICTION PLATES</b>				
250	Forward Clutch (Sintered) (70C, 71C, 72C, 73C) ..... All		5-7	MARINE.FRP01
251	Reverse Brake (Sintered) (70C, 71C, 72C, 73C) ..... All		1-3	MARINE.FRP02
<b>STEEL PLATES</b>				
300	Forward Clutch (70C, 71C, 72C, 73C) ..... All		4-6	MARINE.STP01
301	Reverse Brake (70C, 71C, 72C, 73C) ..... All		0-2	MARINE.STP02
<b>PRESSURE PLATES</b>				
<b>SPRINGS &amp; CIRCLIPS</b>				

ILL NO.	DESCRIPTION	YEARS	QTY	PART NO
<b>FILTERS</b>				
<b>BUSHINGS</b>				
550	Output Carrier to Case..... TO-78		2	MARINE.BUS04
551	Output Carrier Front..... All		2	MARINE.BUS03
<b>THRUST WASHERS &amp; BEARINGS</b>				
<b>ELECTRICAL COMPONENTS</b>				
<b>VALVE BODY PARTS</b>				
<b>HARD PARTS</b>				
<b>SPECIAL ITEMS</b>				
<b>TOOLS &amp; MANUALS</b>				