

A

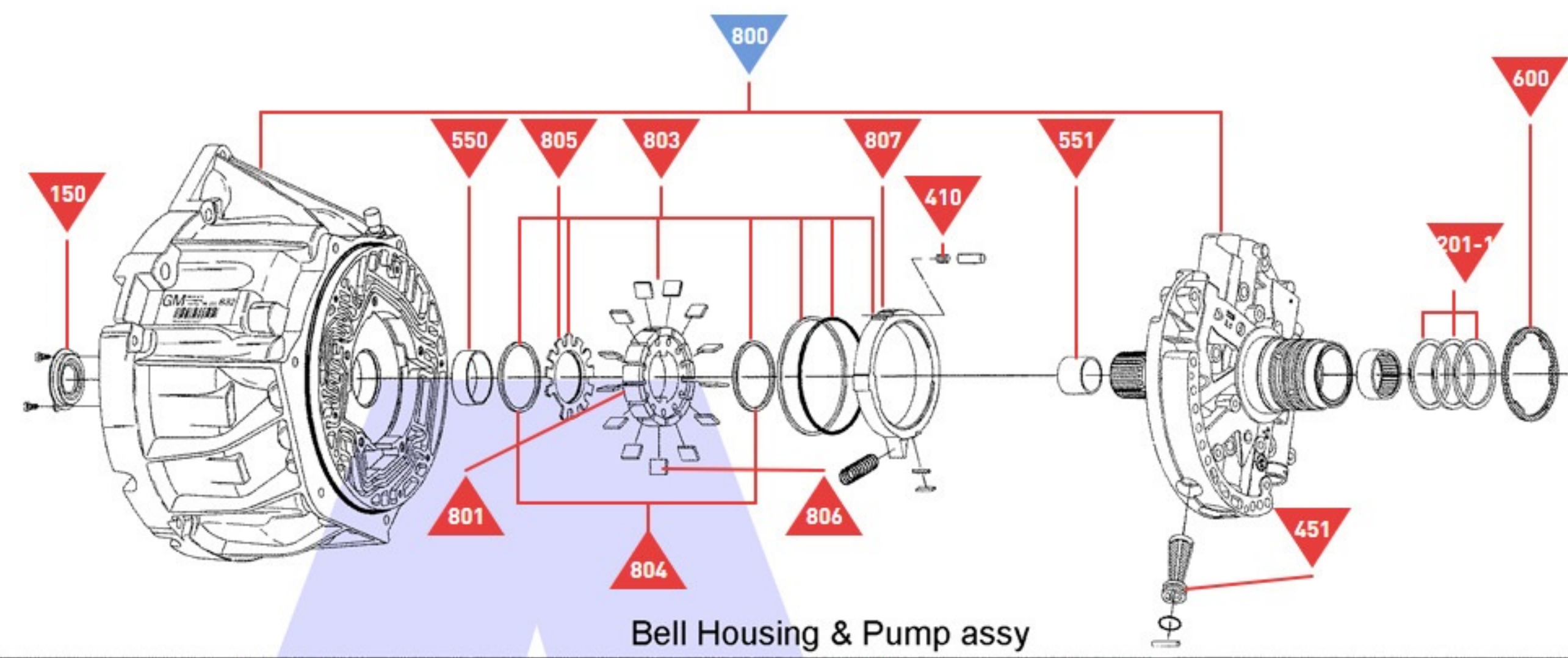

Bell Housing & Pump assy

B

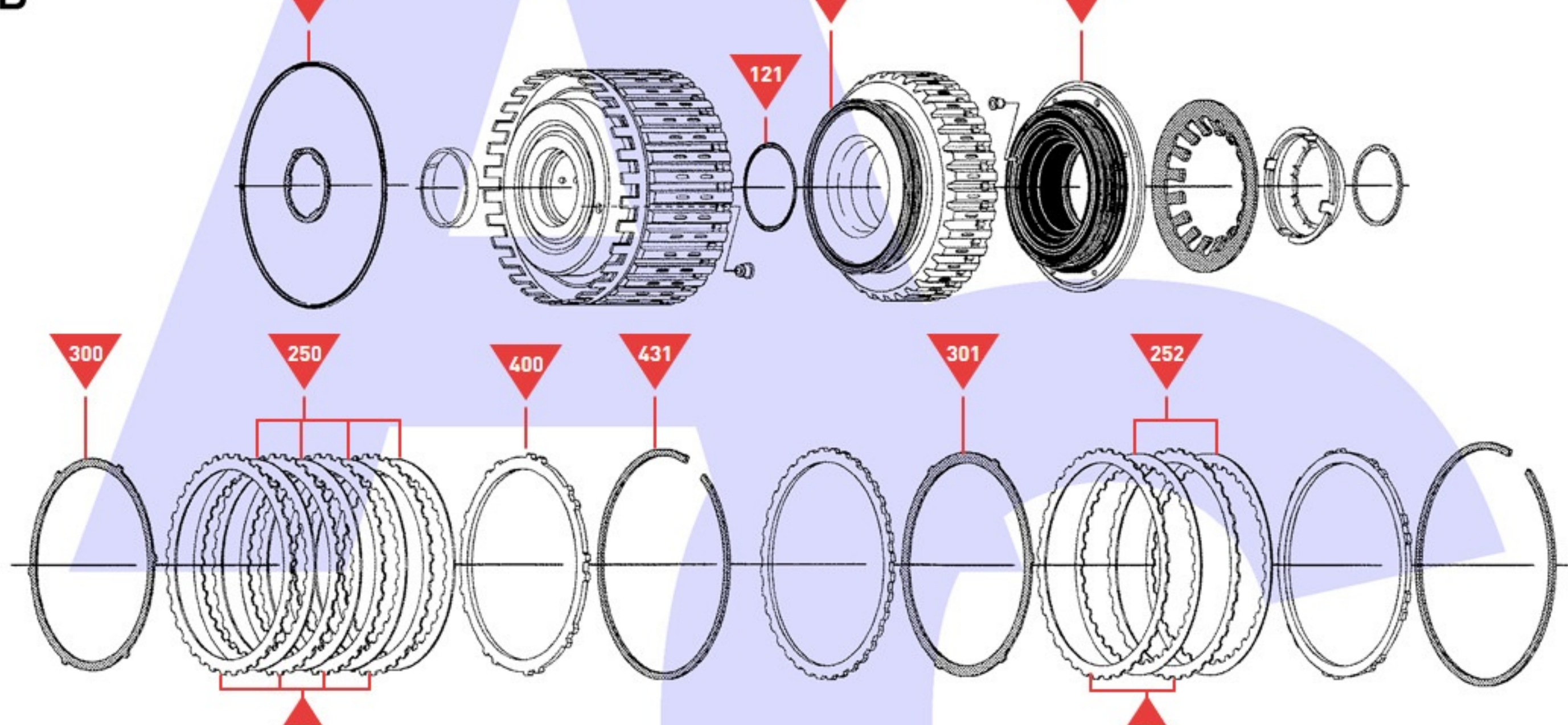

Direct Clutch Assy

Reverse Clutch Assy

C

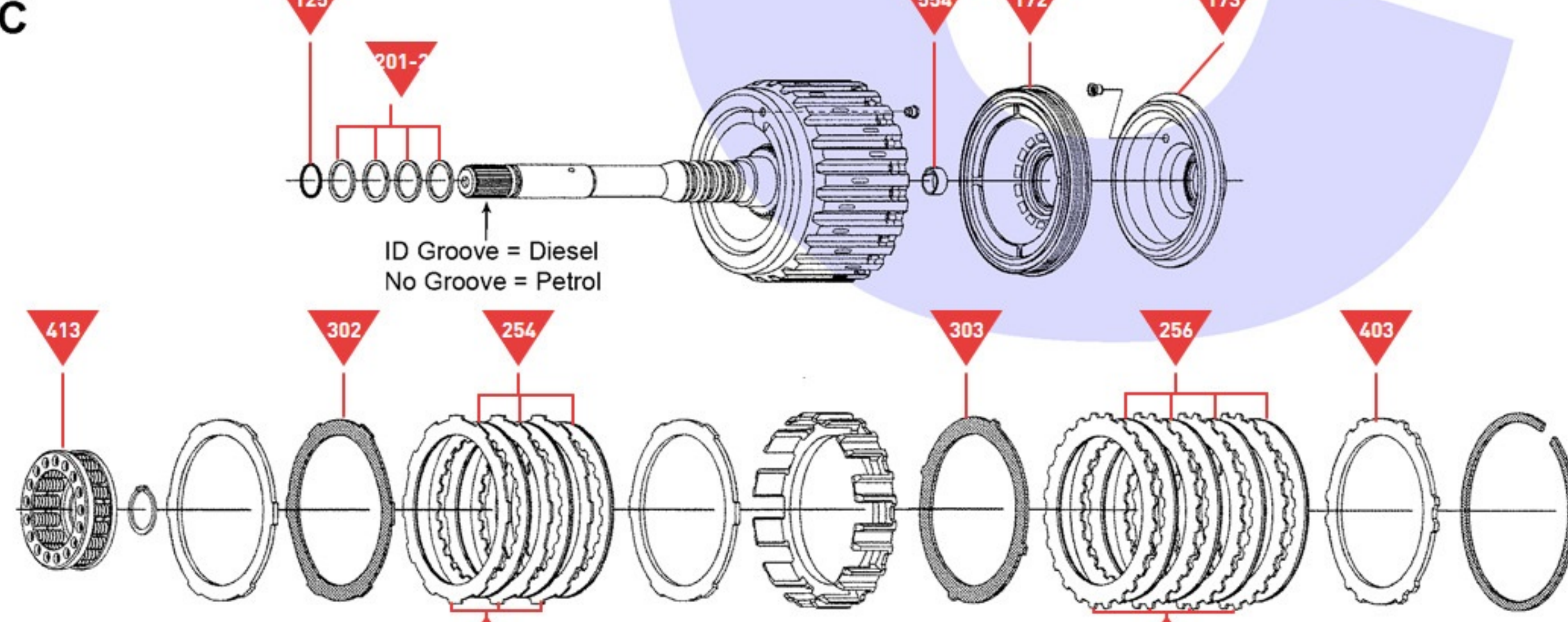

Coast Clutch Assy

Forward Clutch Assy

D

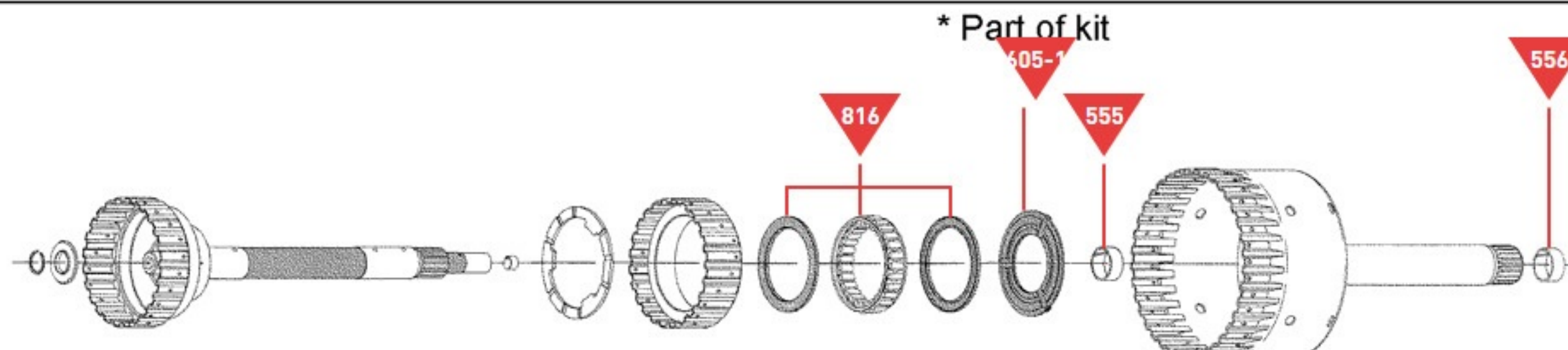

Forward Sprag, Direct Drum & Shaft Assy

E

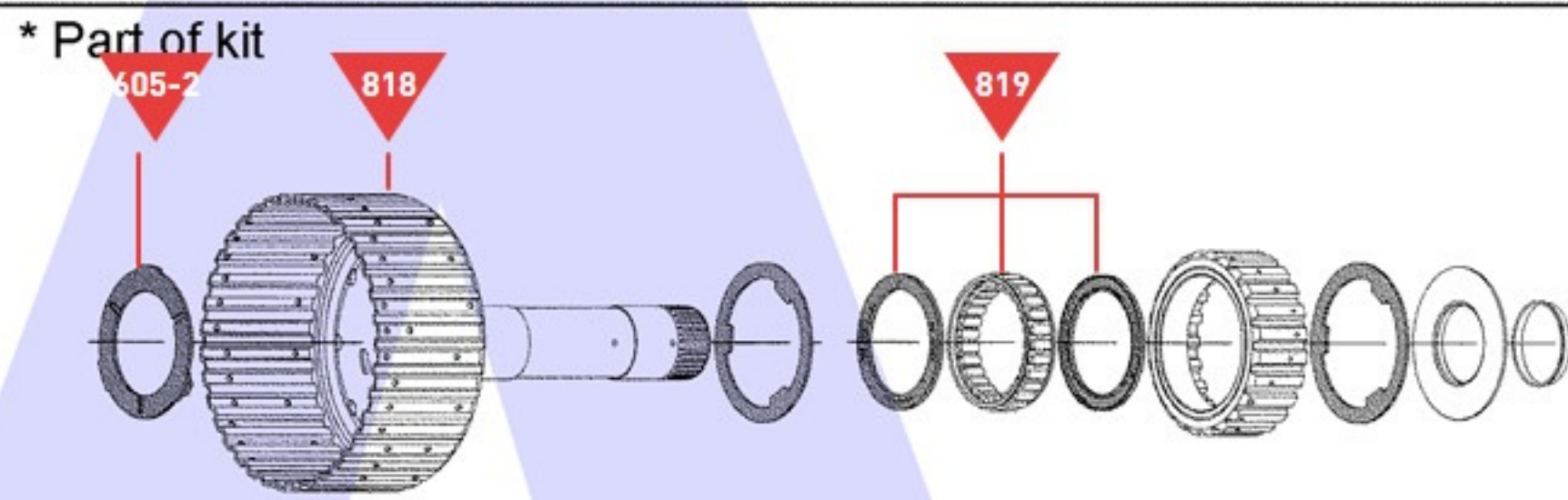

Overdrive Clutch Hub & Intermediate Sprag Assy

F

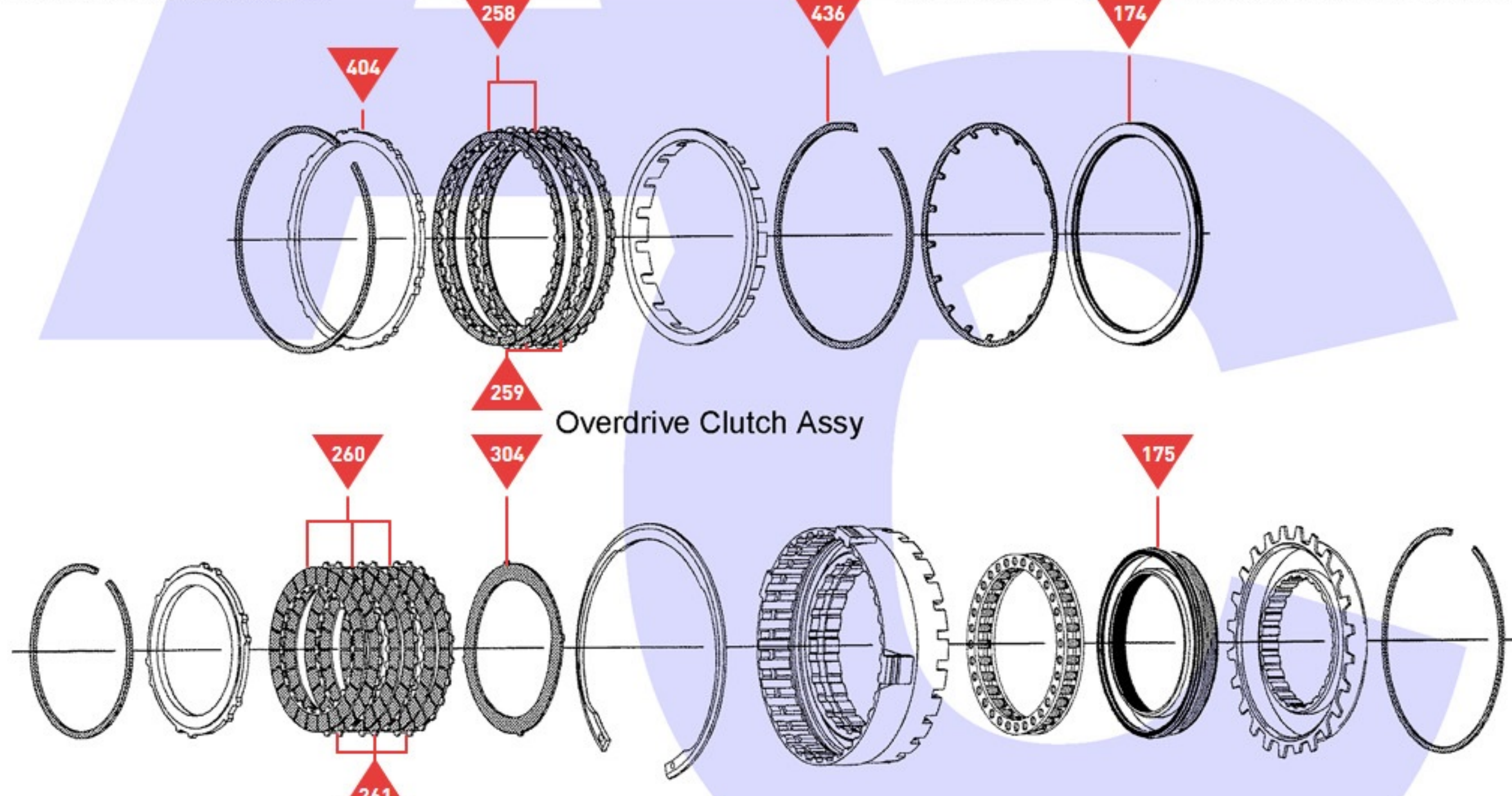

Overdrive Clutch Assy

Intermediate Clutch Assy

G

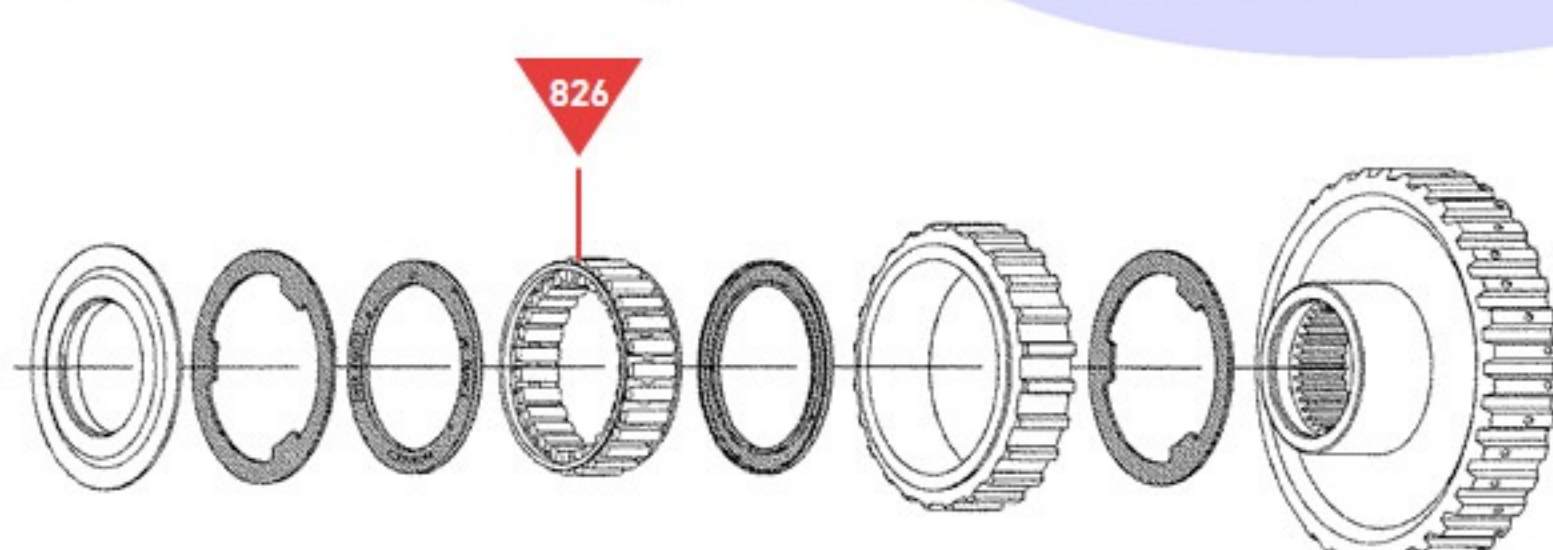

Low Sprag Assy

H

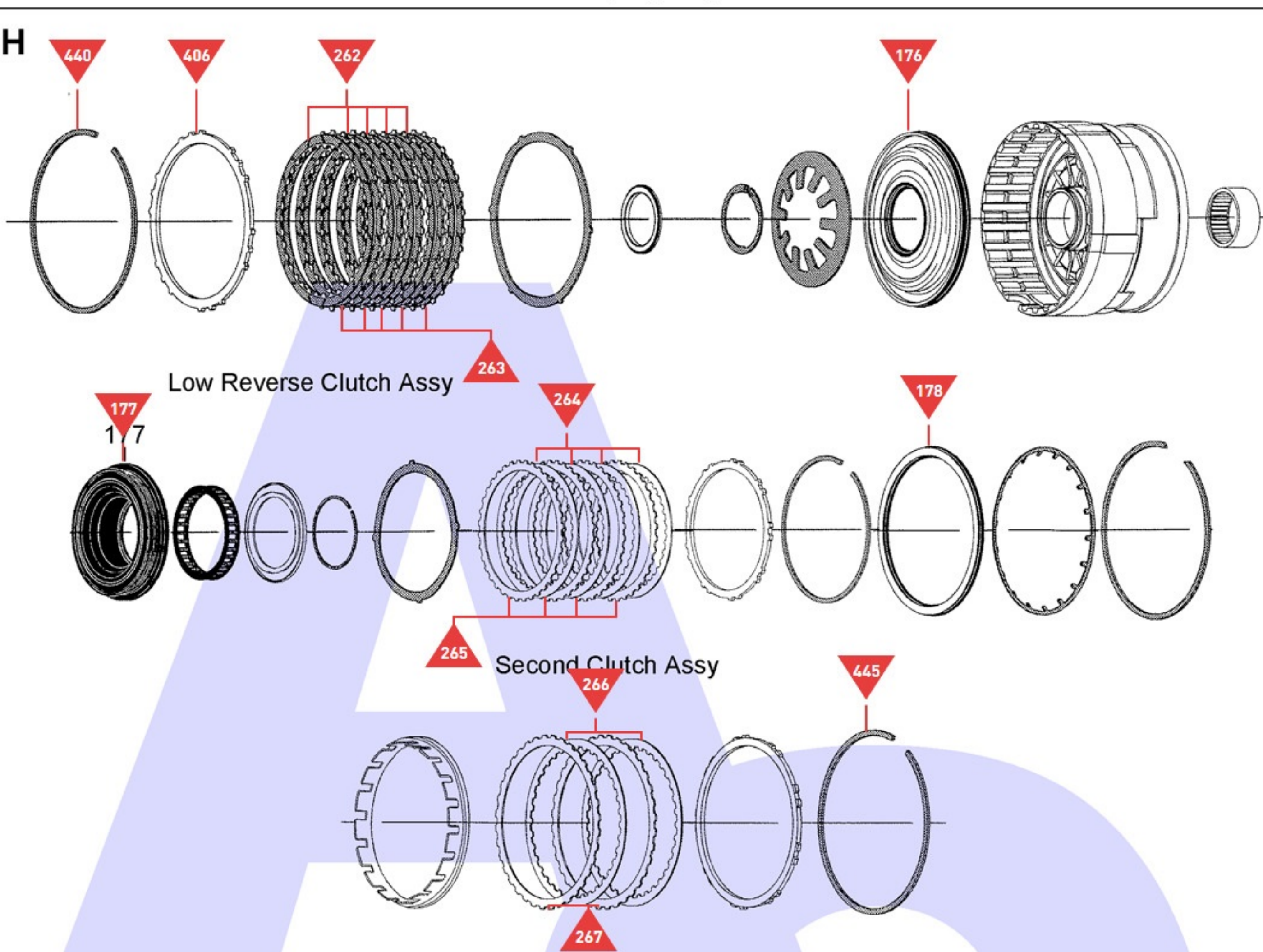

Low Reverse Clutch Assy

Second Clutch Assy

Second Coast Clutch Assy (Not Used on 4L40E)

J

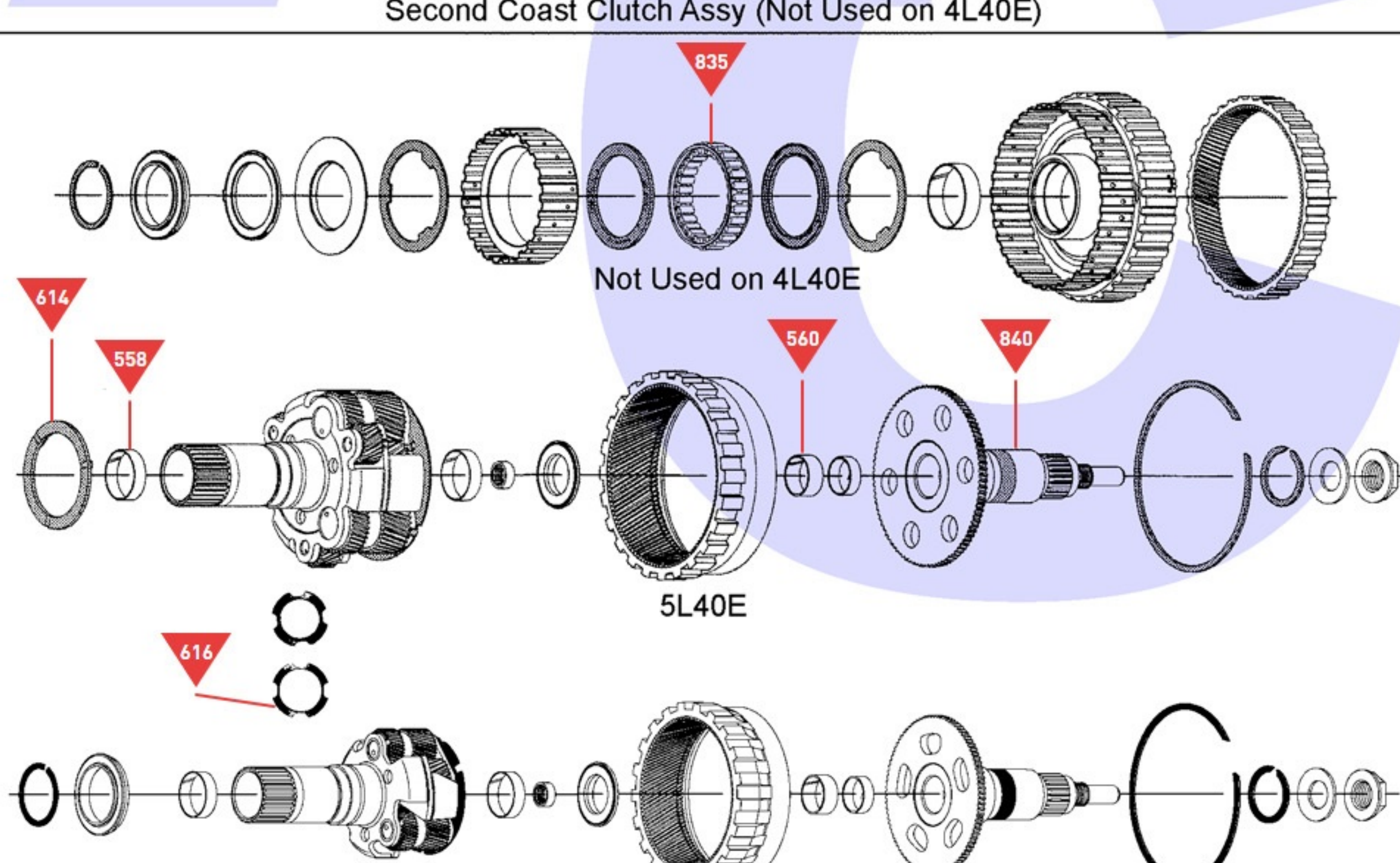

5L40E

4L40E

Second Sprag & Planetary Assy

K

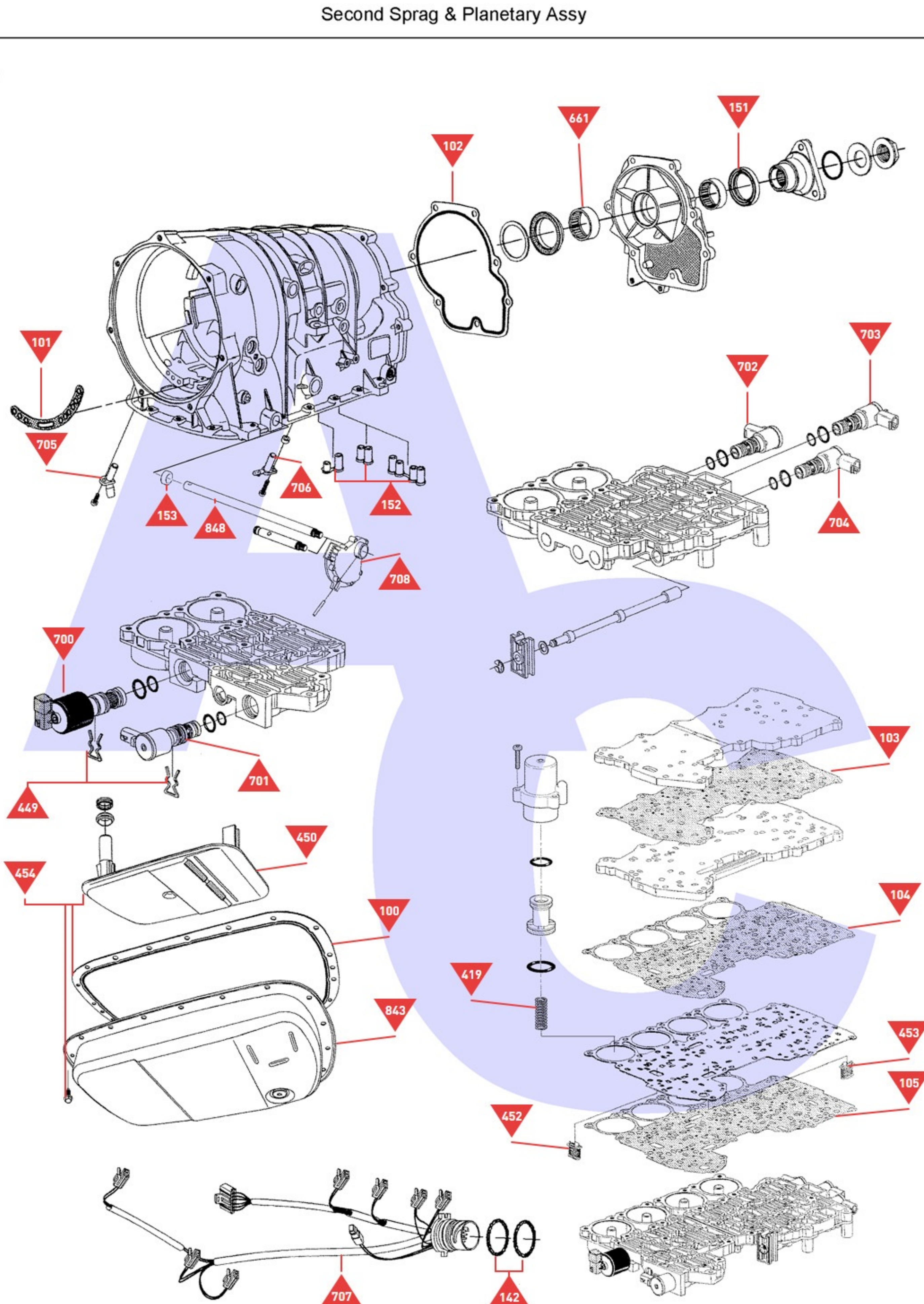

Casing, Valve Body & Electrical Components