

A

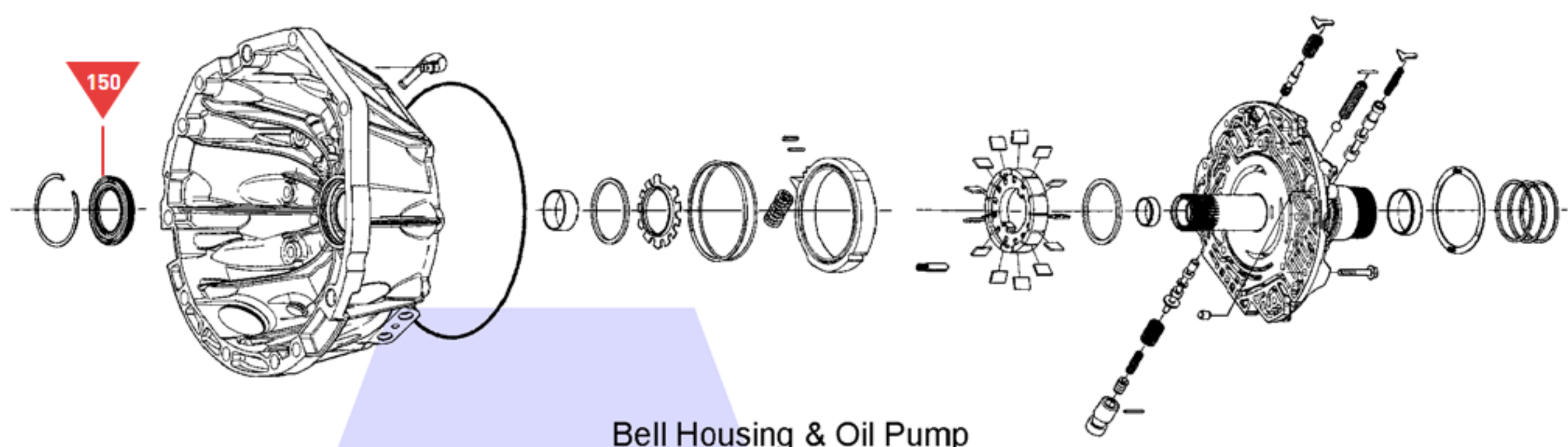

Bell Housing & Oil Pump

B

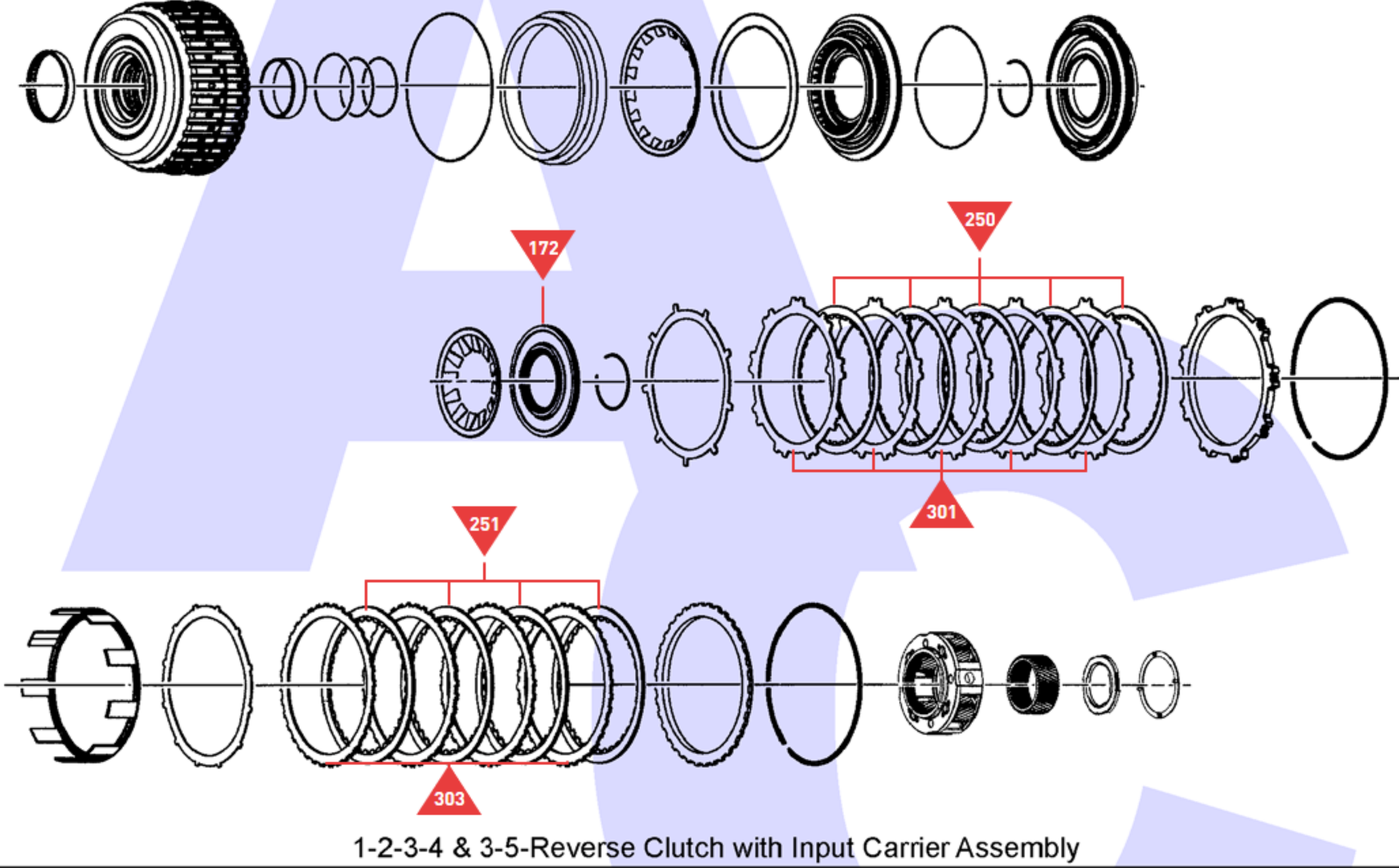

1-2-3-4 & 3-5-Reverse Clutch with Input Carrier Assembly

C

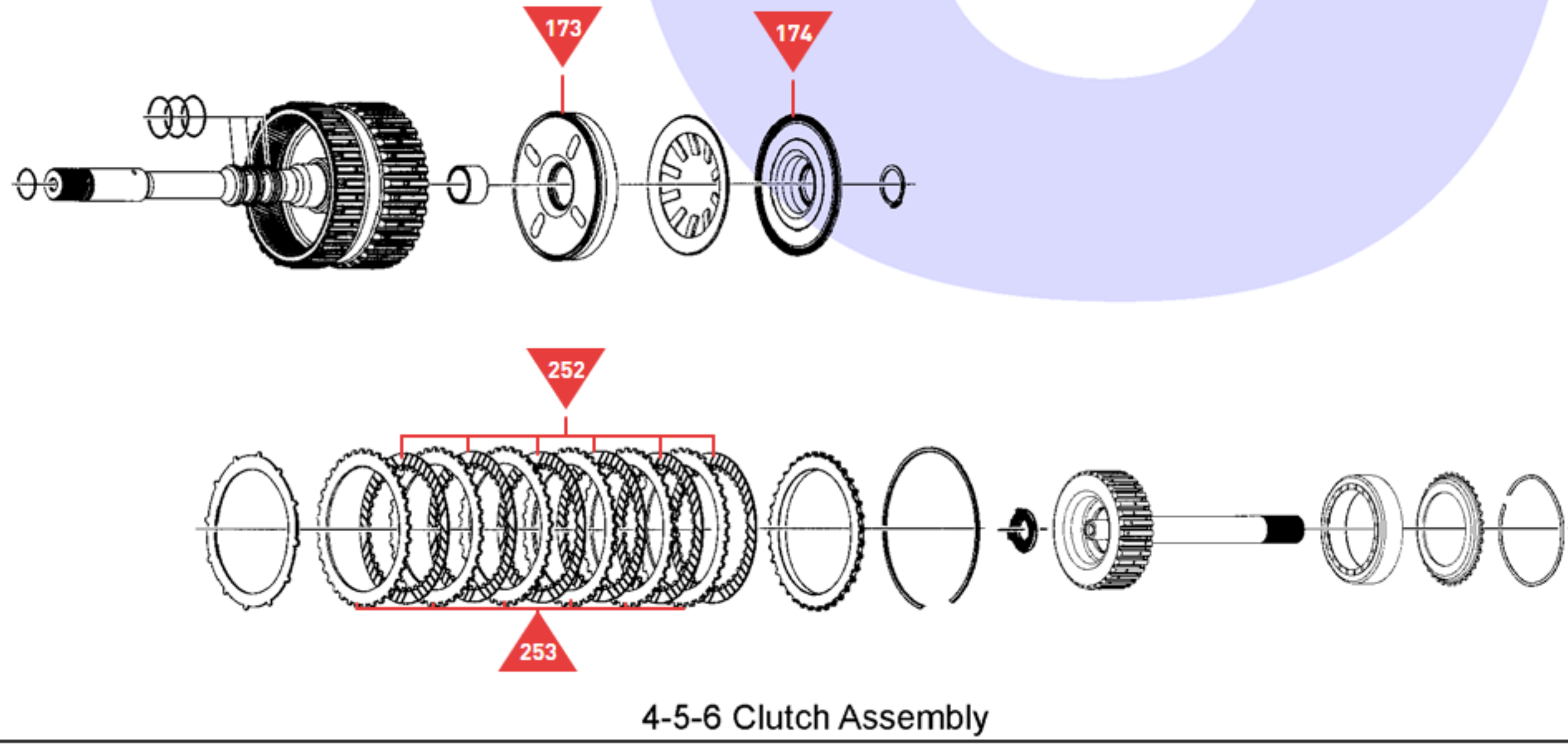

4-5-6 Clutch Assembly

D

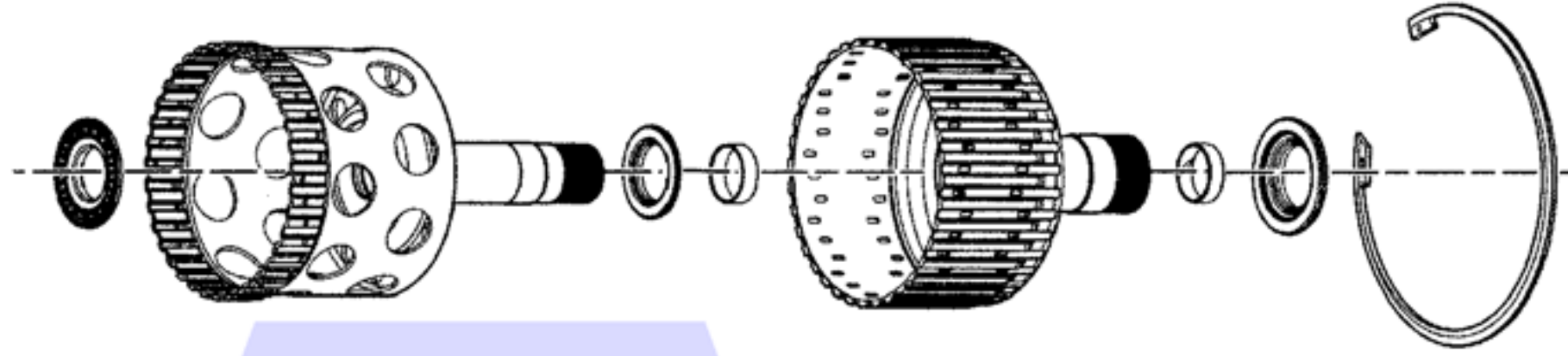

1-2-3-4 Clutch Hub, 2-6 & 3-5-Reverse Clutch Hub

E

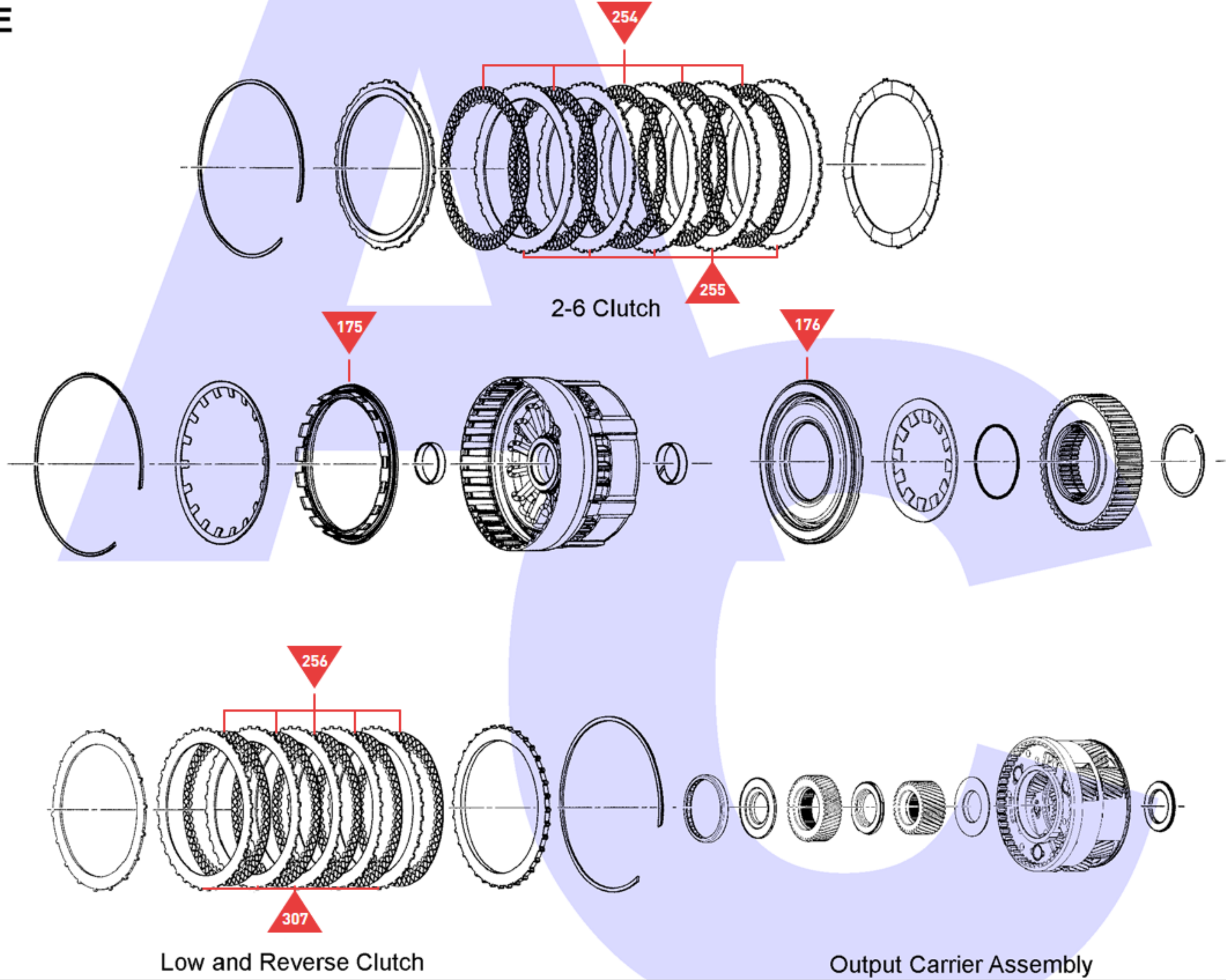

Low and Reverse Clutch

Output Carrier Assembly

F

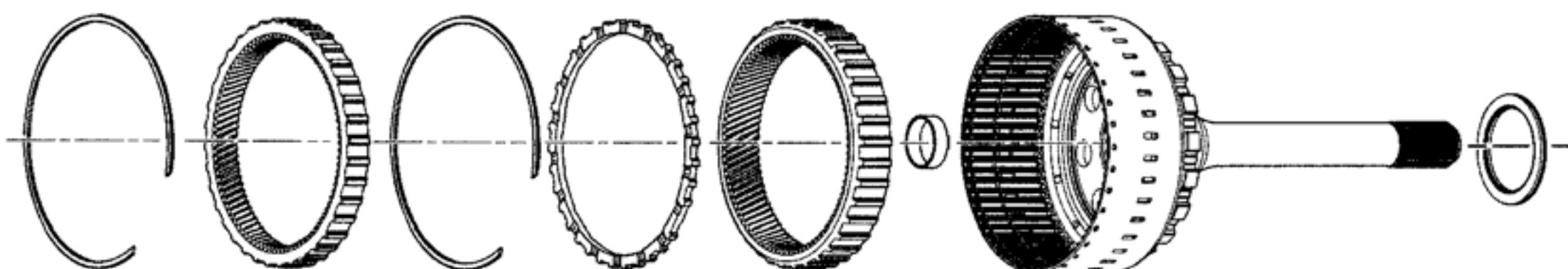

Output Shaft Assembly

G

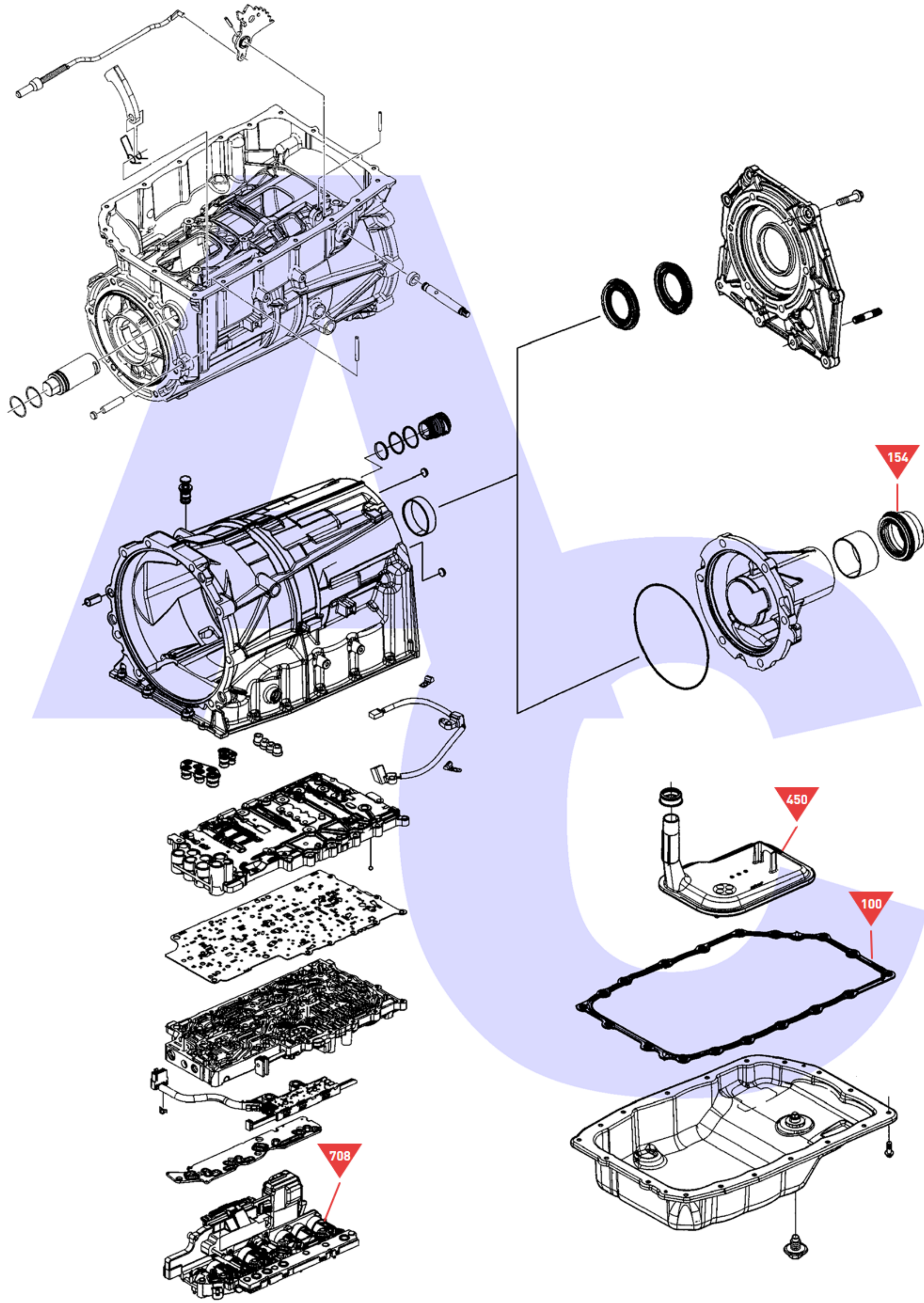

Case Components, Valve Body, Oil Filter & Oil Pan