

A

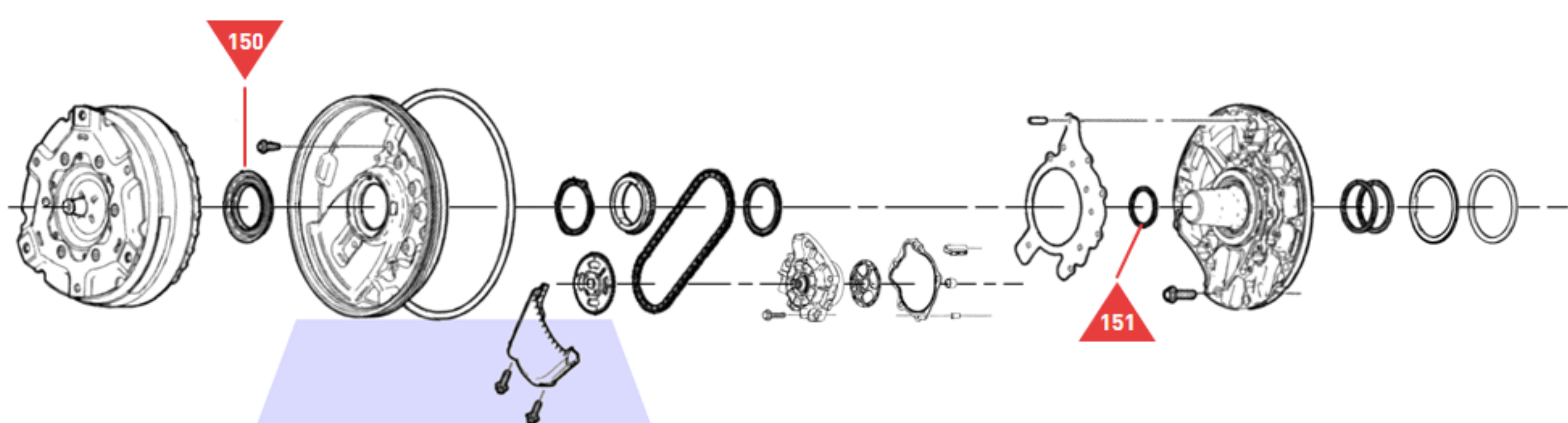

Torque Converter, Front Cover, Pump Drive, Pump and Stator Support

B

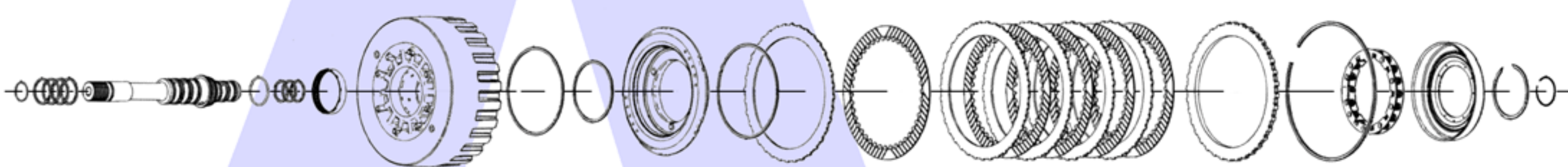

1-3-5-6-7 ('C3') Clutch

C

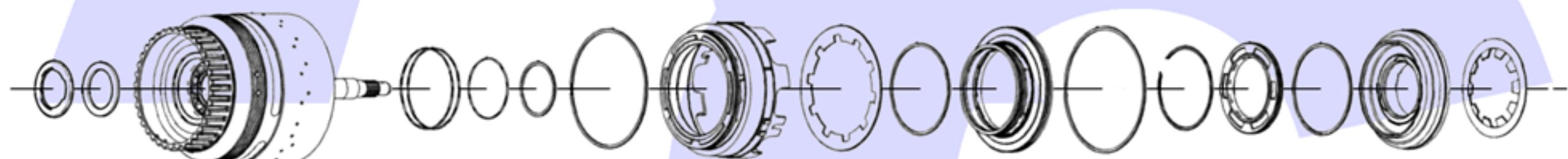

2-3-4-6-8 & 4-5-6-7-8-Rev Clutch Housing & Pistons

D



4-5-6-7-8-Rev Clutch

2-3-4-6-8 Clutch

E

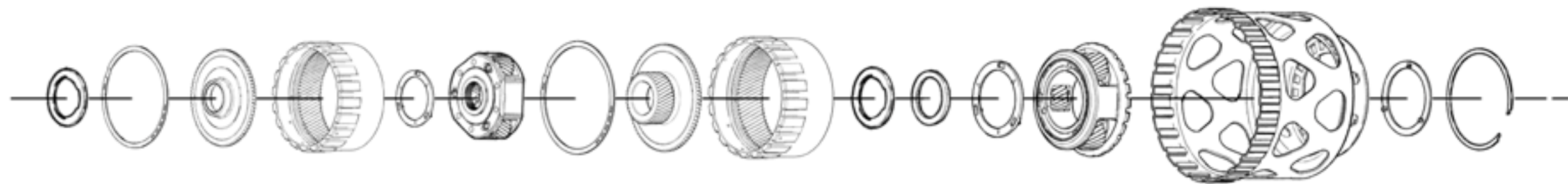

Direct/O.D. Internal Gear & Carrier, Input Internal Gear & Carrier

F

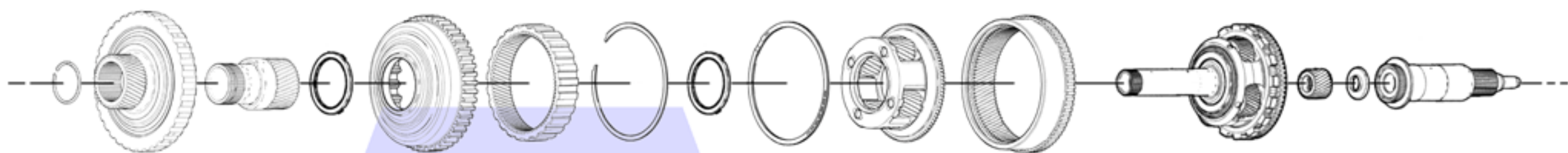

Input Sun Gear, Reaction Internal Gear & Carrier, Output Carrier & Output Shaft

G

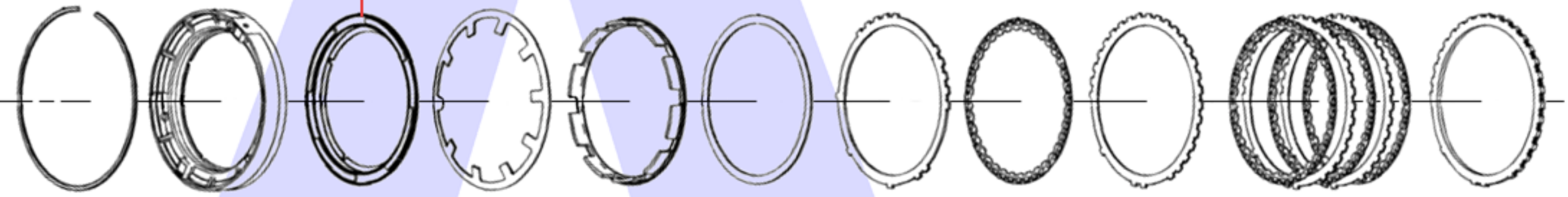

1-2-7-8-Rev Clutch

H

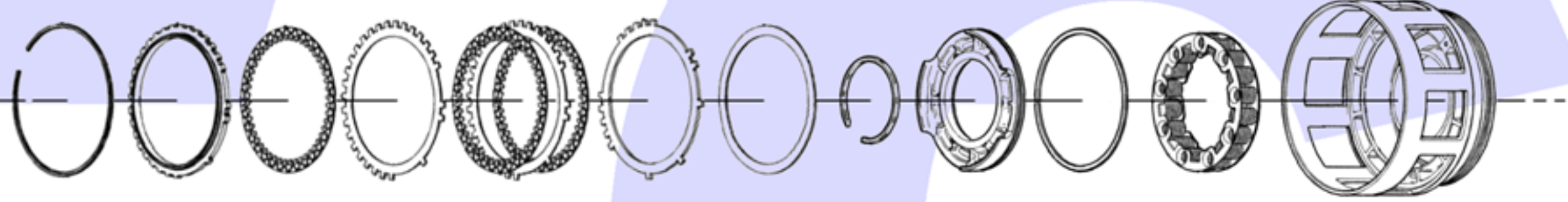

1-2-3-4-5-Rev Clutch

J

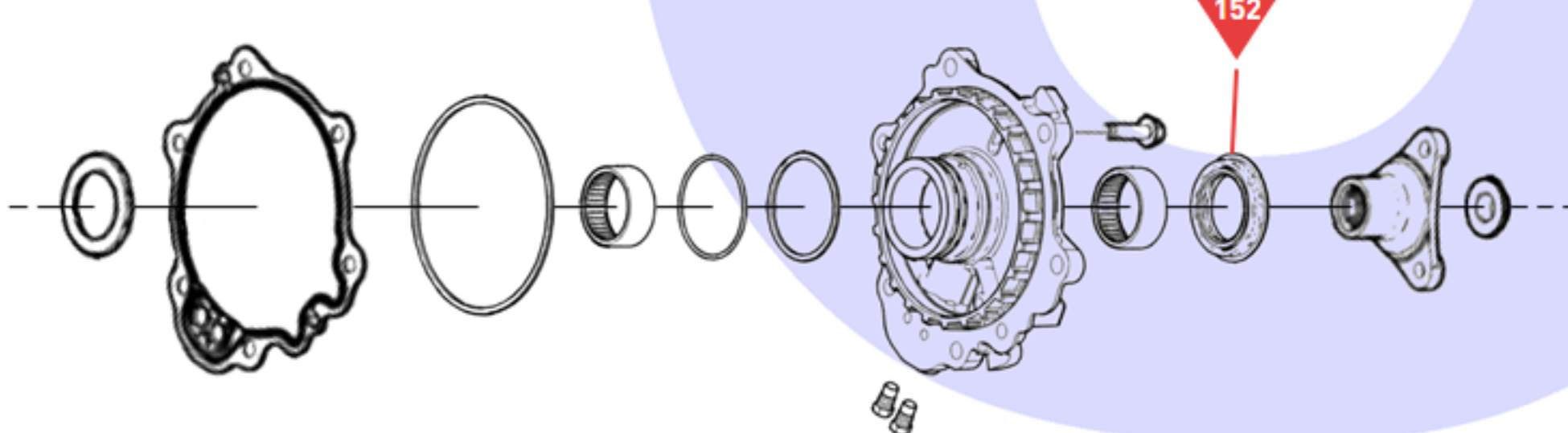

Extension Housing & Output Flange

K

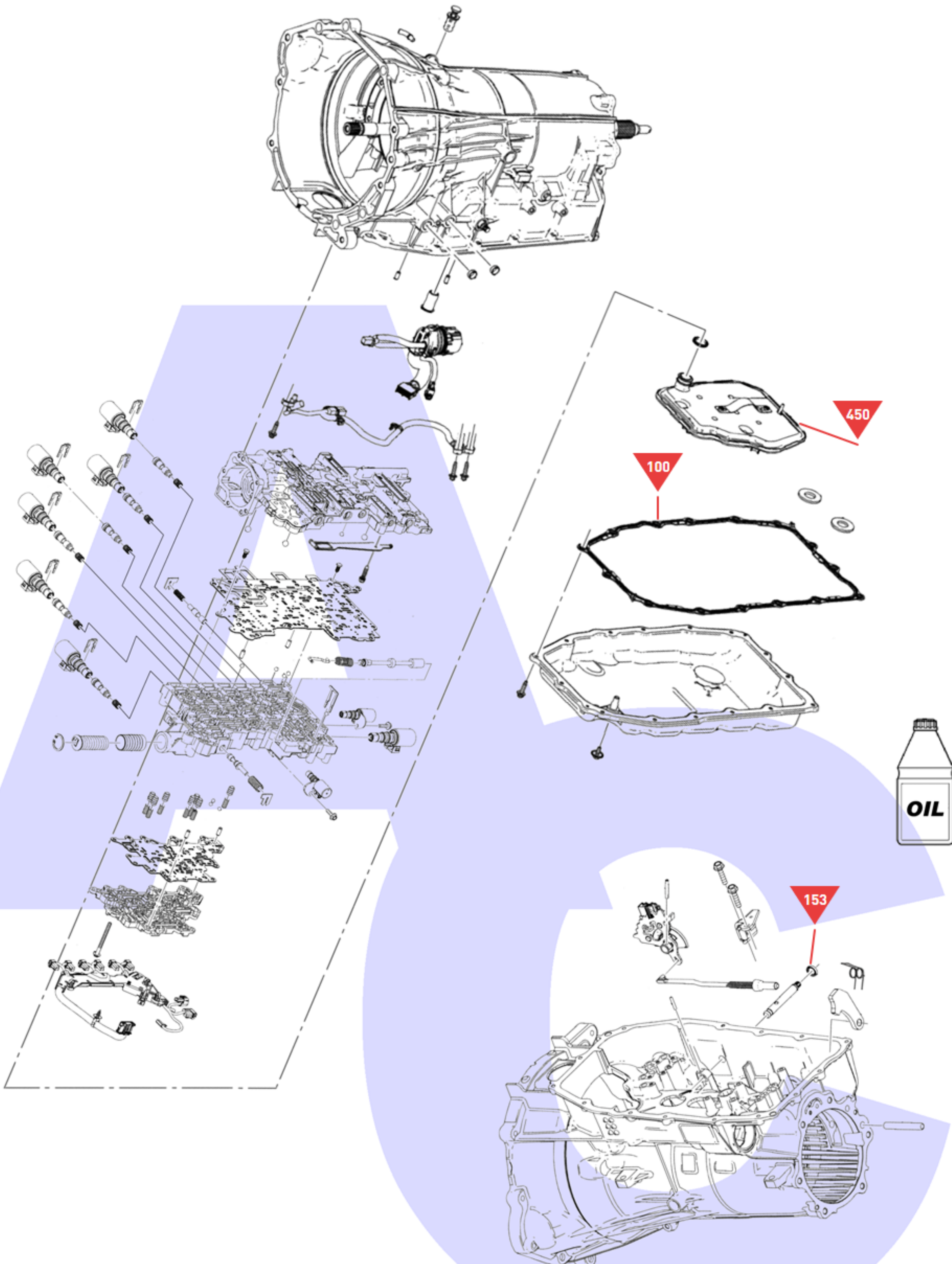

Main Casing, Valve Body, Oil Pan, Filter & Associated Components