

A6GF Identification

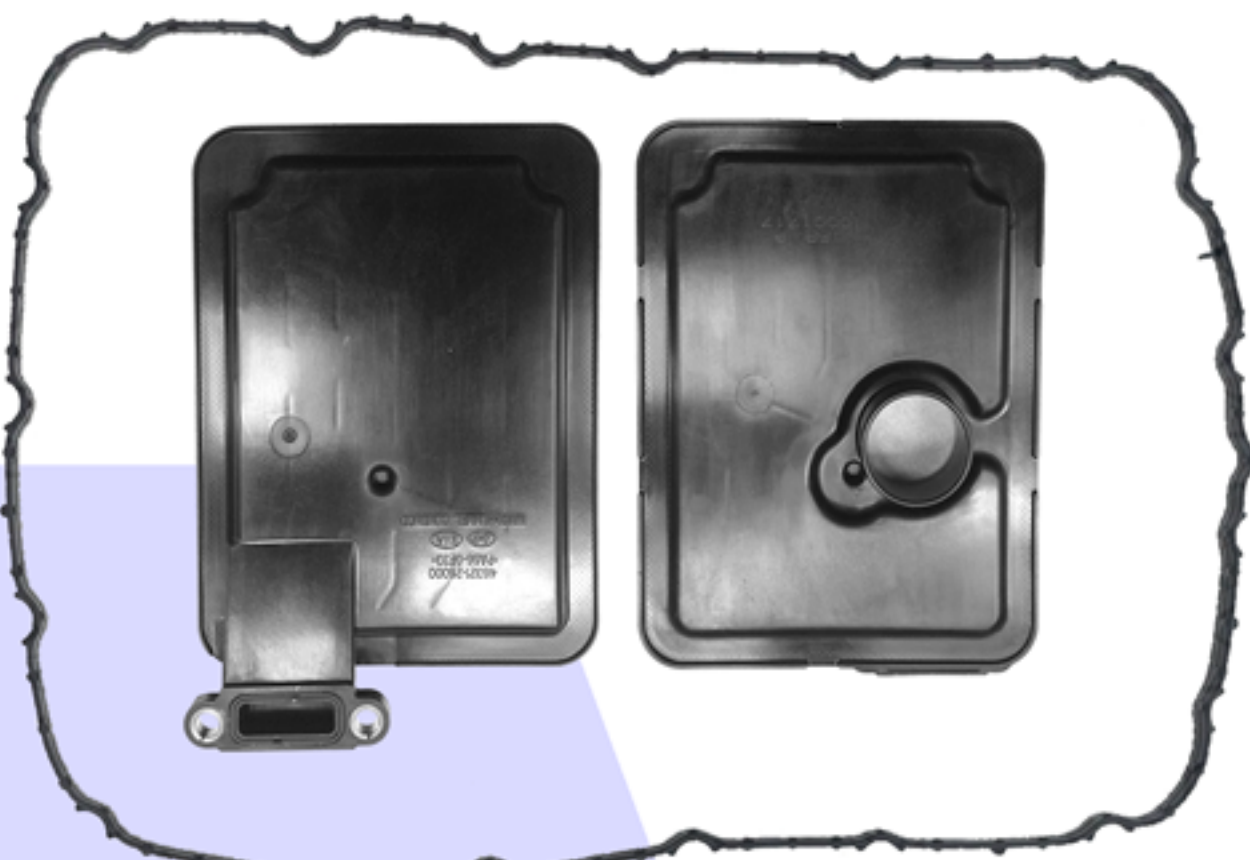

A6GF Pan Gasket and Filter

A



Pump Assembly

2-6 Brake Assembly

B

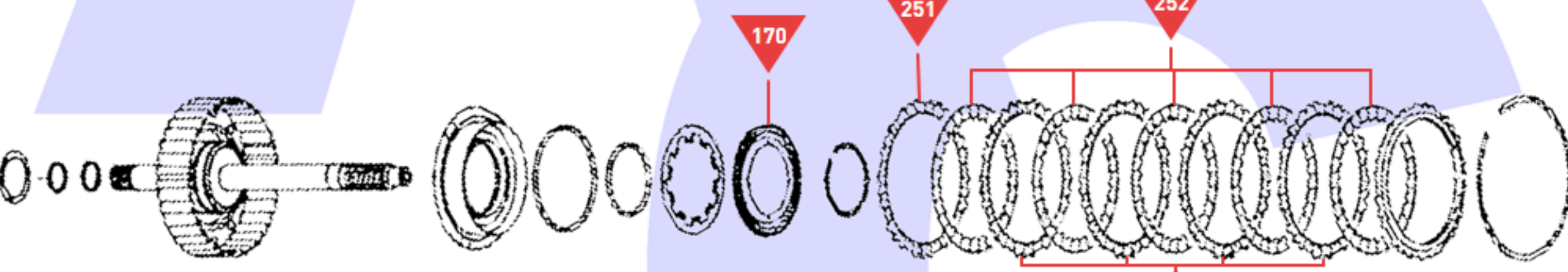

3-5-R Clutch Assembly

C

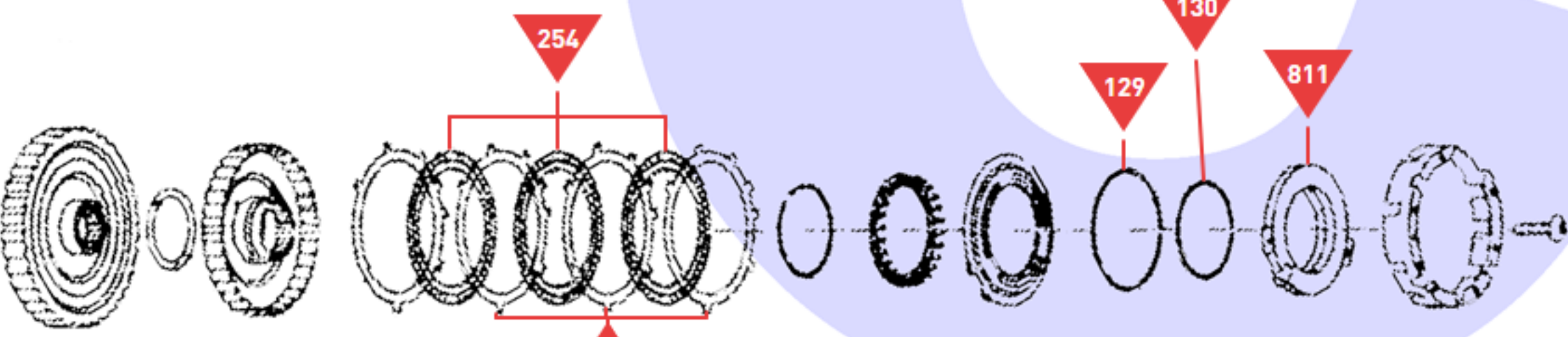

Underdrive Brake Assembly

D

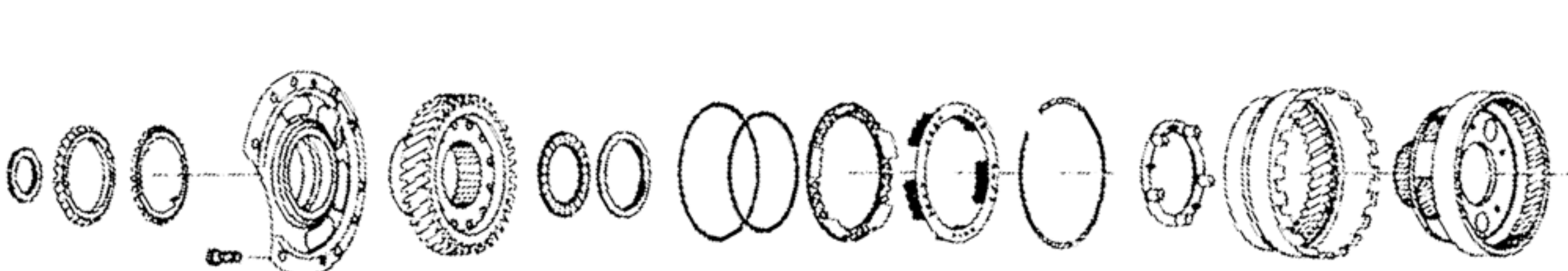

Output Drive Gear

Reverse Piston, Front Anulus & Front Planetary

E



Front Sun Gear, Mid & Rear Planet, Sun Gear

F

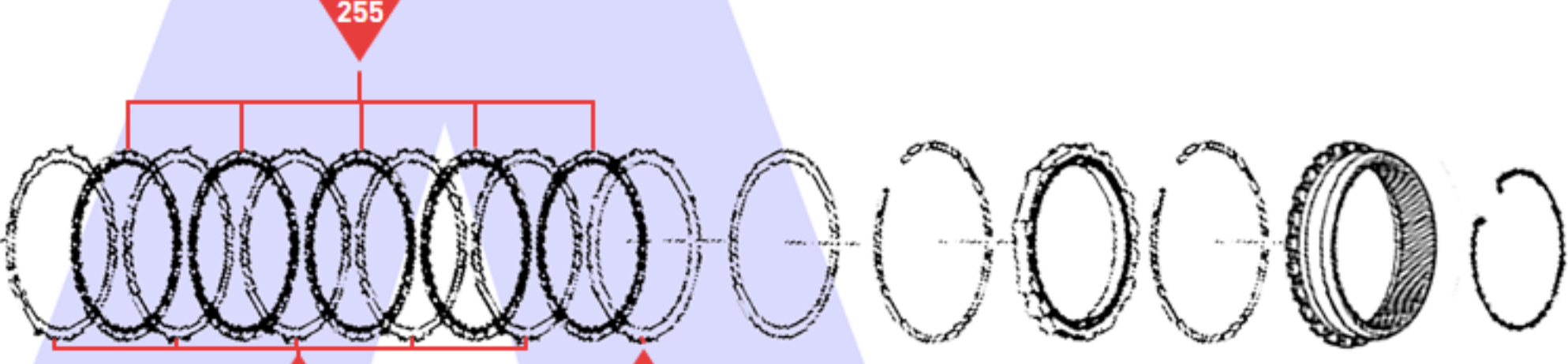

Low & Reverse Brake, One Way Clutch & Inner Race

G

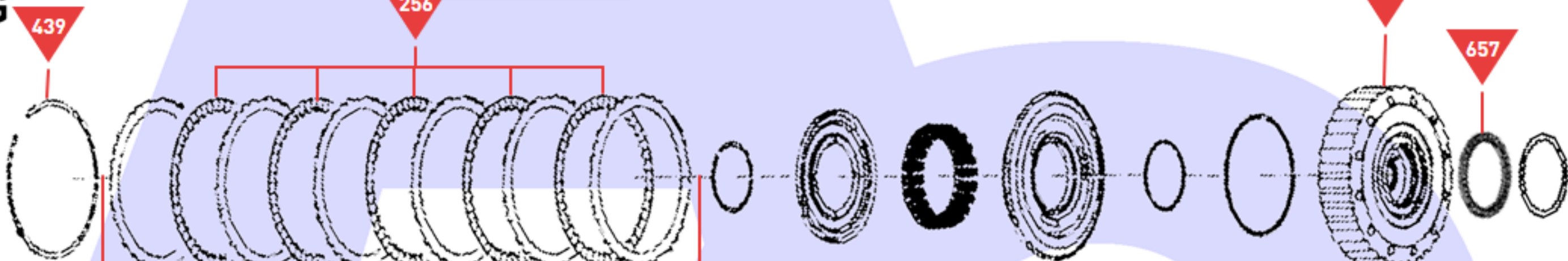

Overdrive Clutch Assembly

H

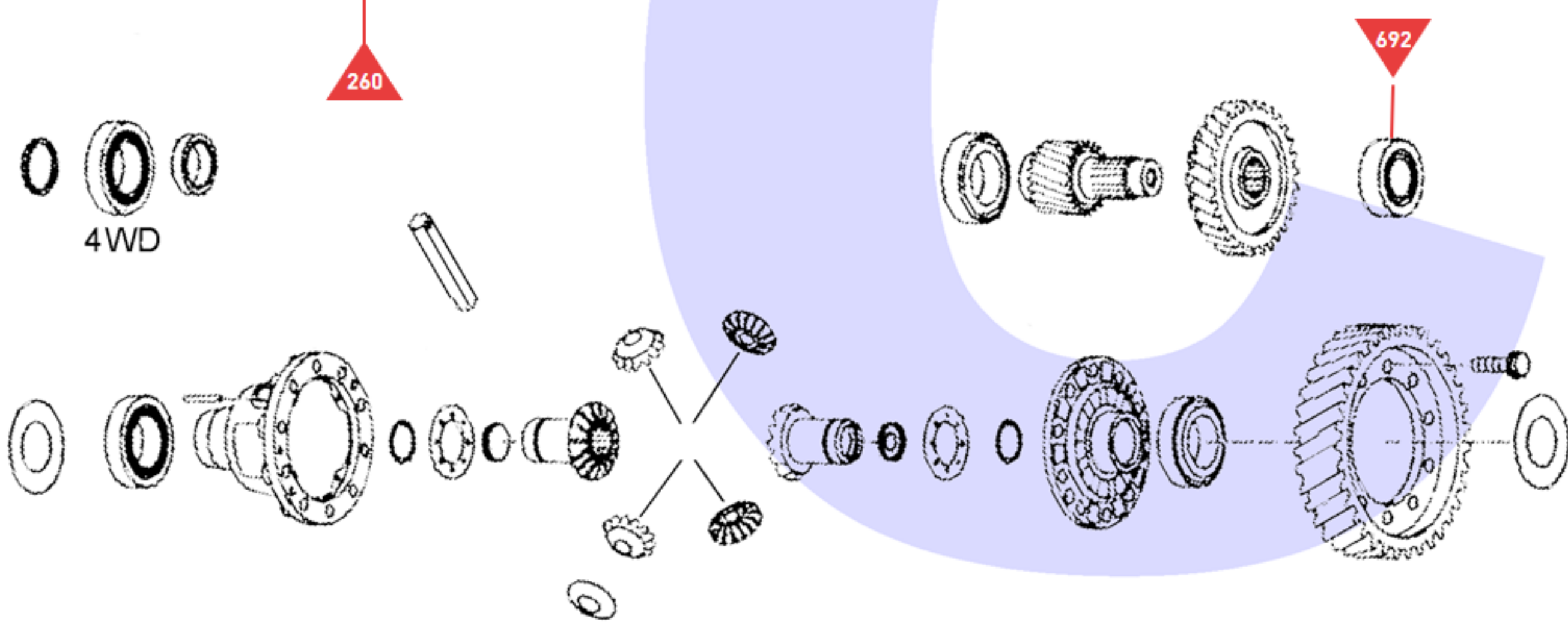

Transfer Gear & Differential Assembly

J

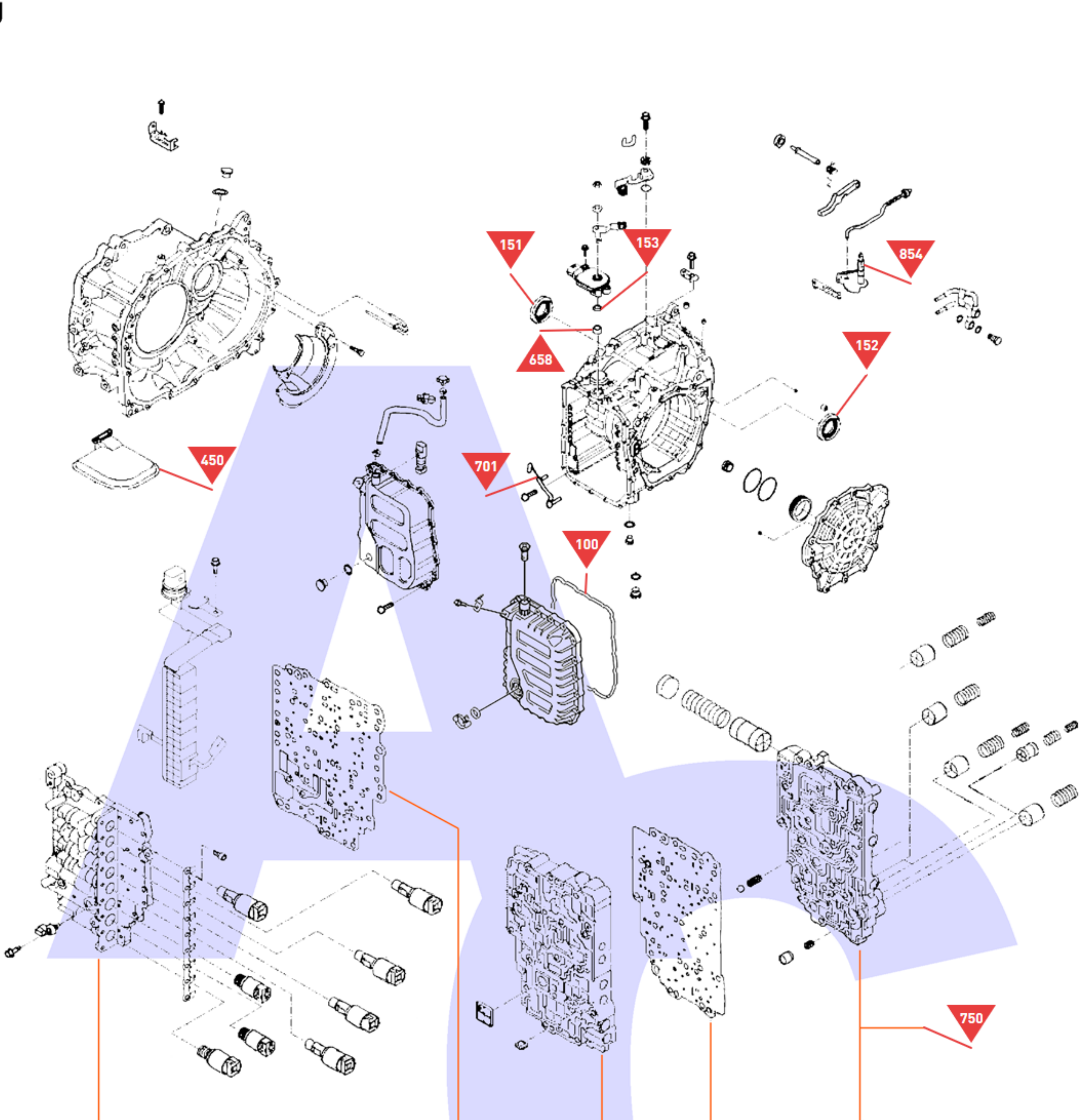

Casing and Valve Body Components

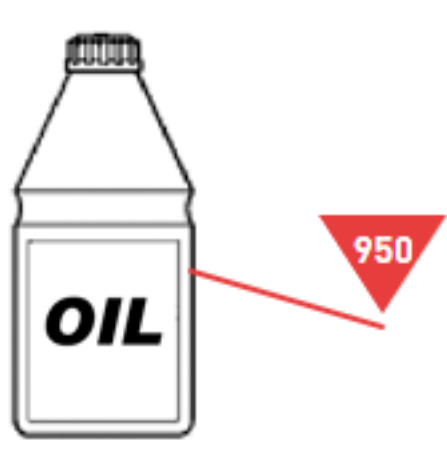

950