

A

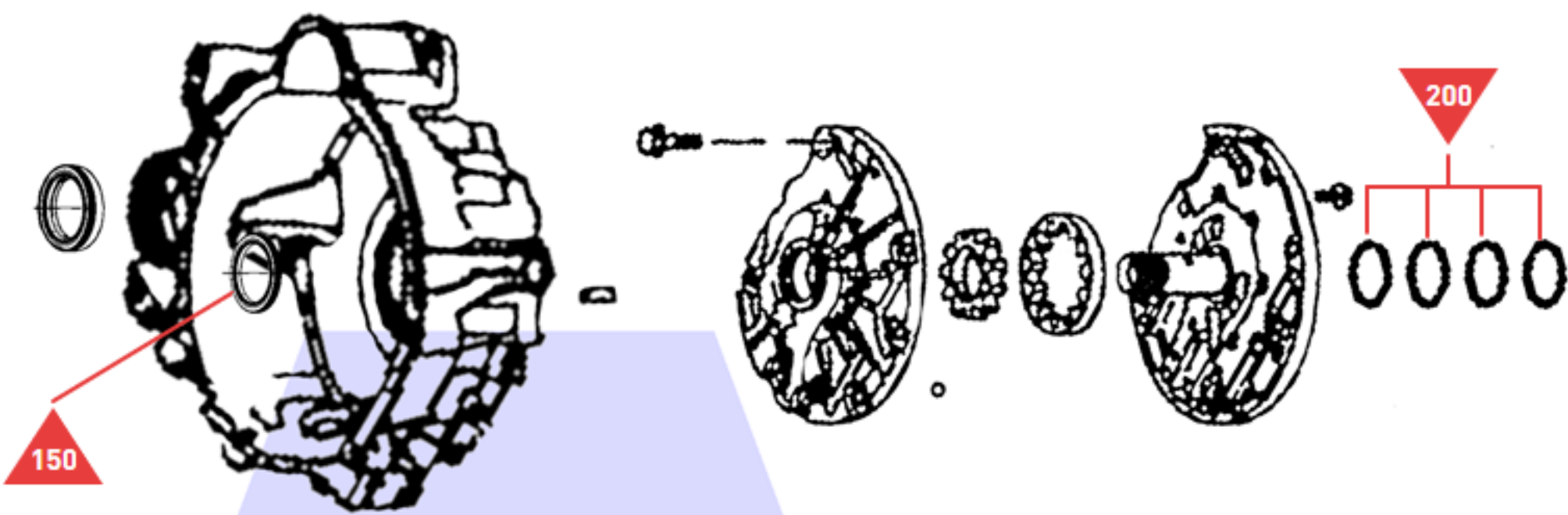

Oil Pump

B

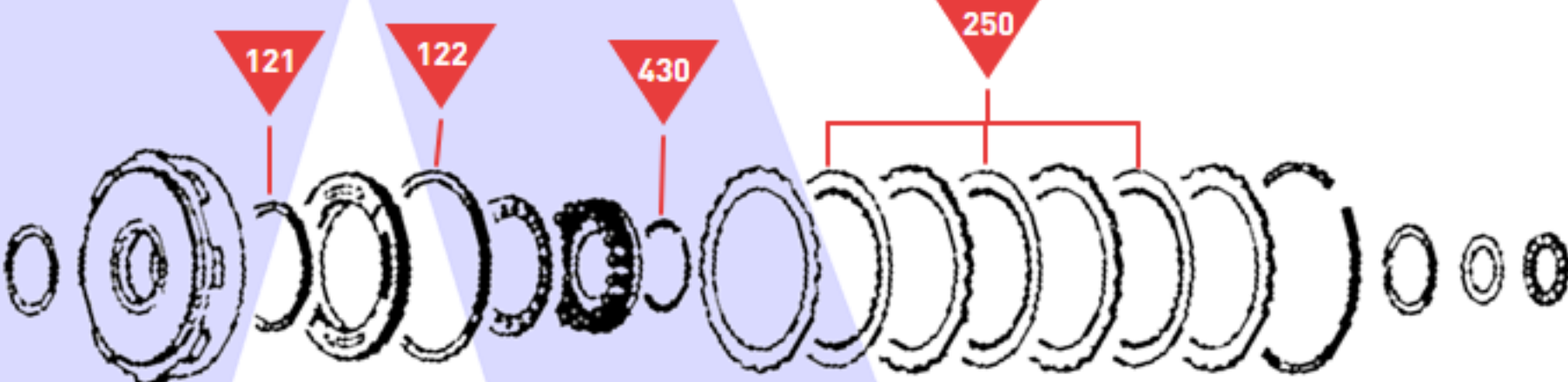

Front (Direct) Clutch

C

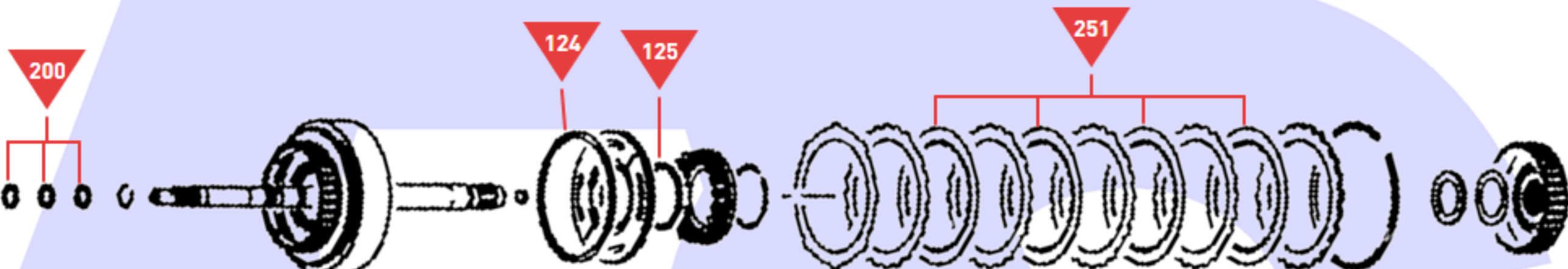

Rear (Forward) Clutch

D

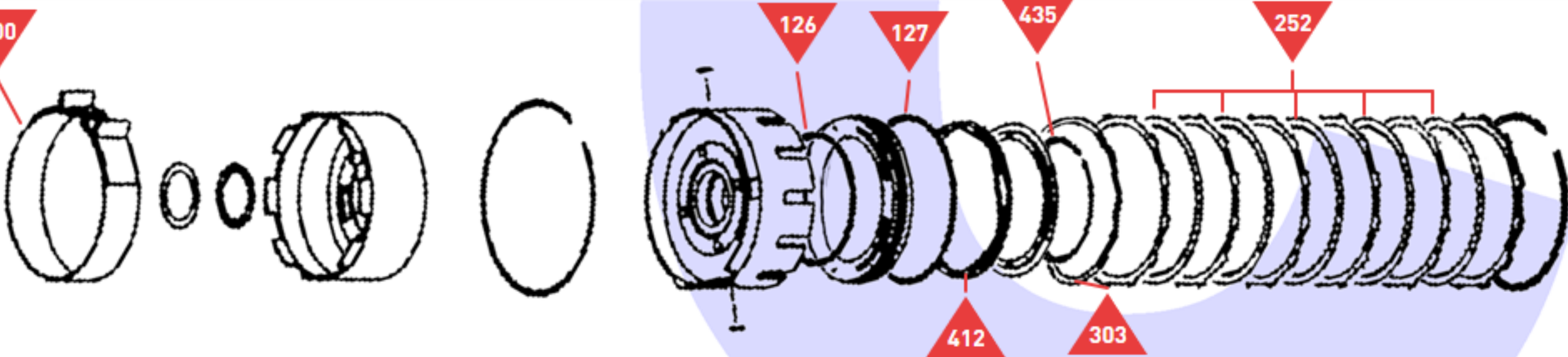

2-4 Band and Low Reverse Brake

E

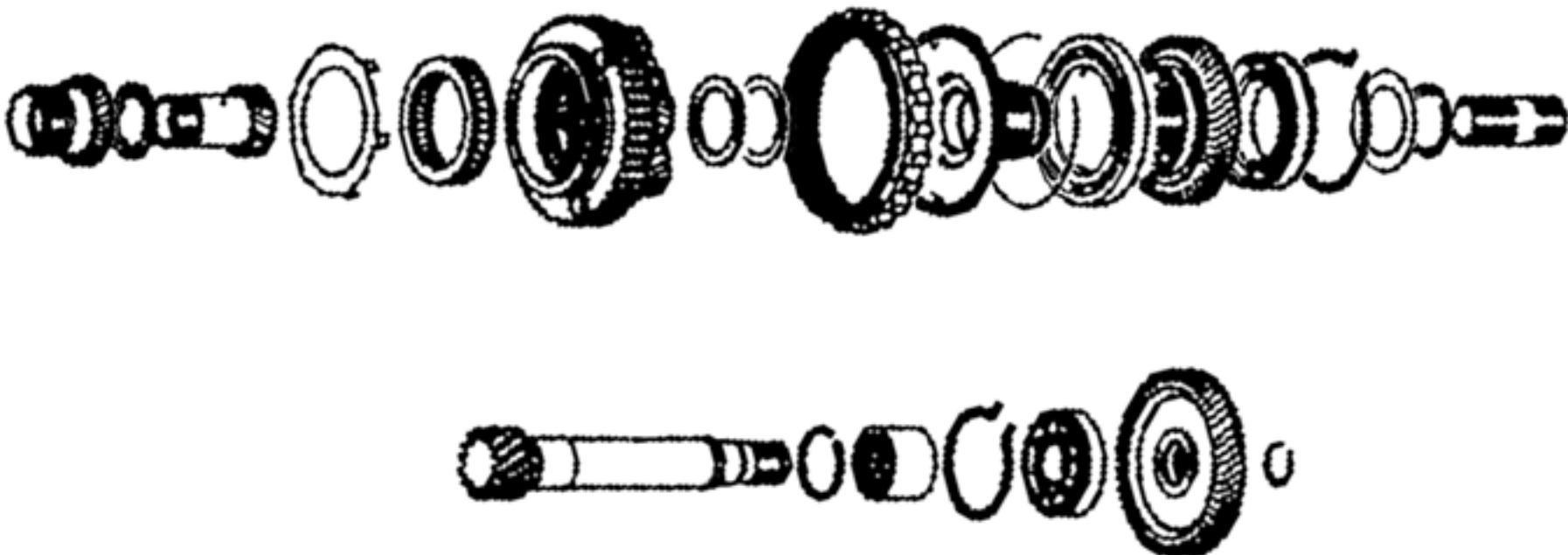

Sun Gears, One-Way-Clutch, Planetary, Transfer Gears and Pinion Shaft

F

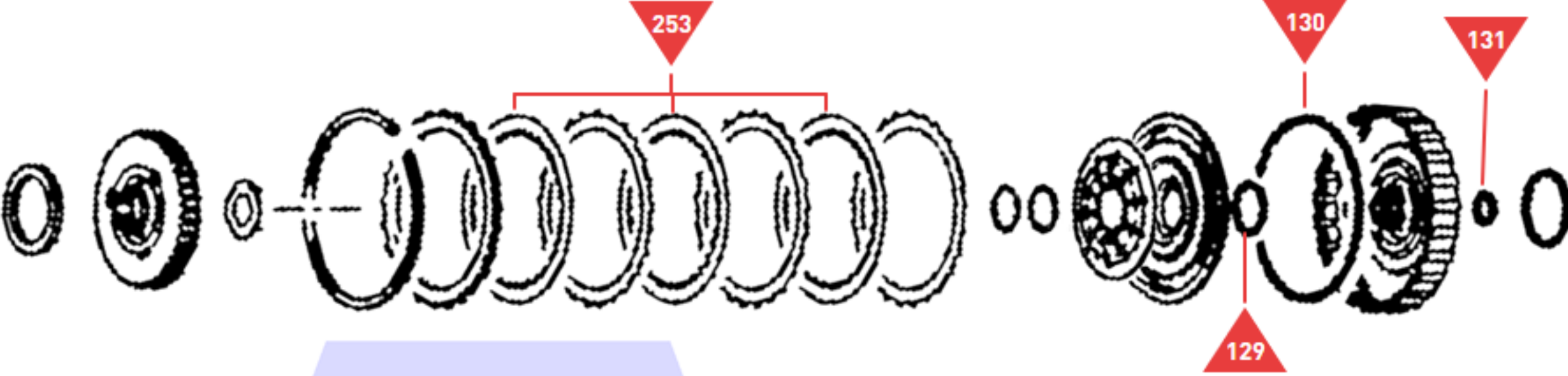

End (Overdrive) Clutch

G

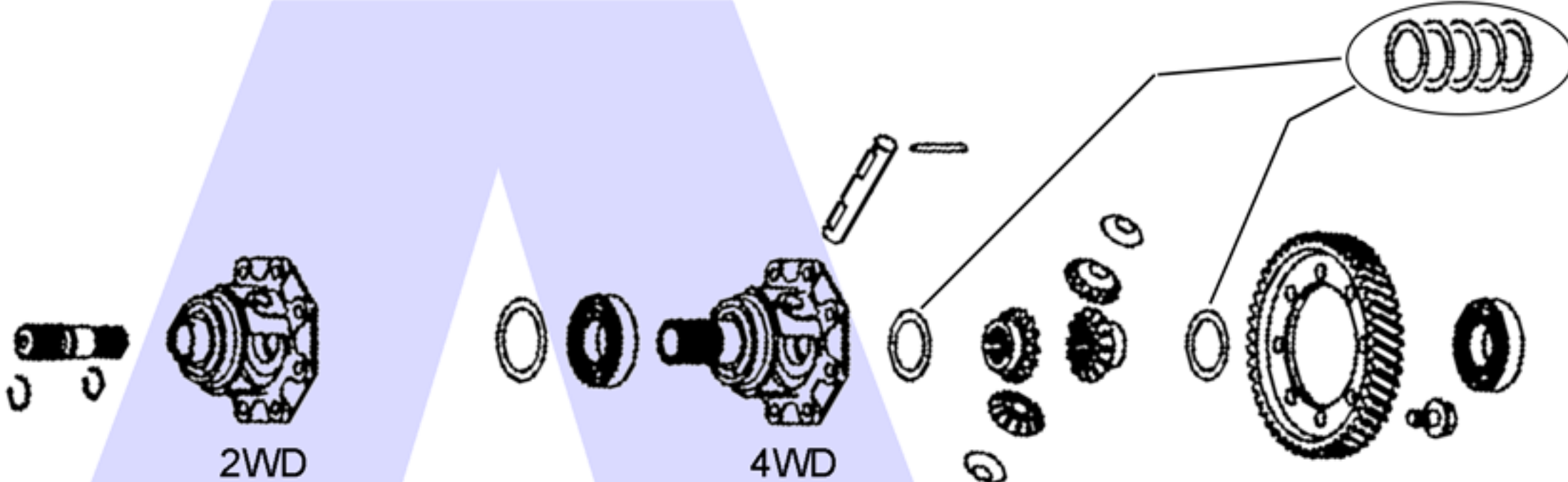

Differential Assembly

H

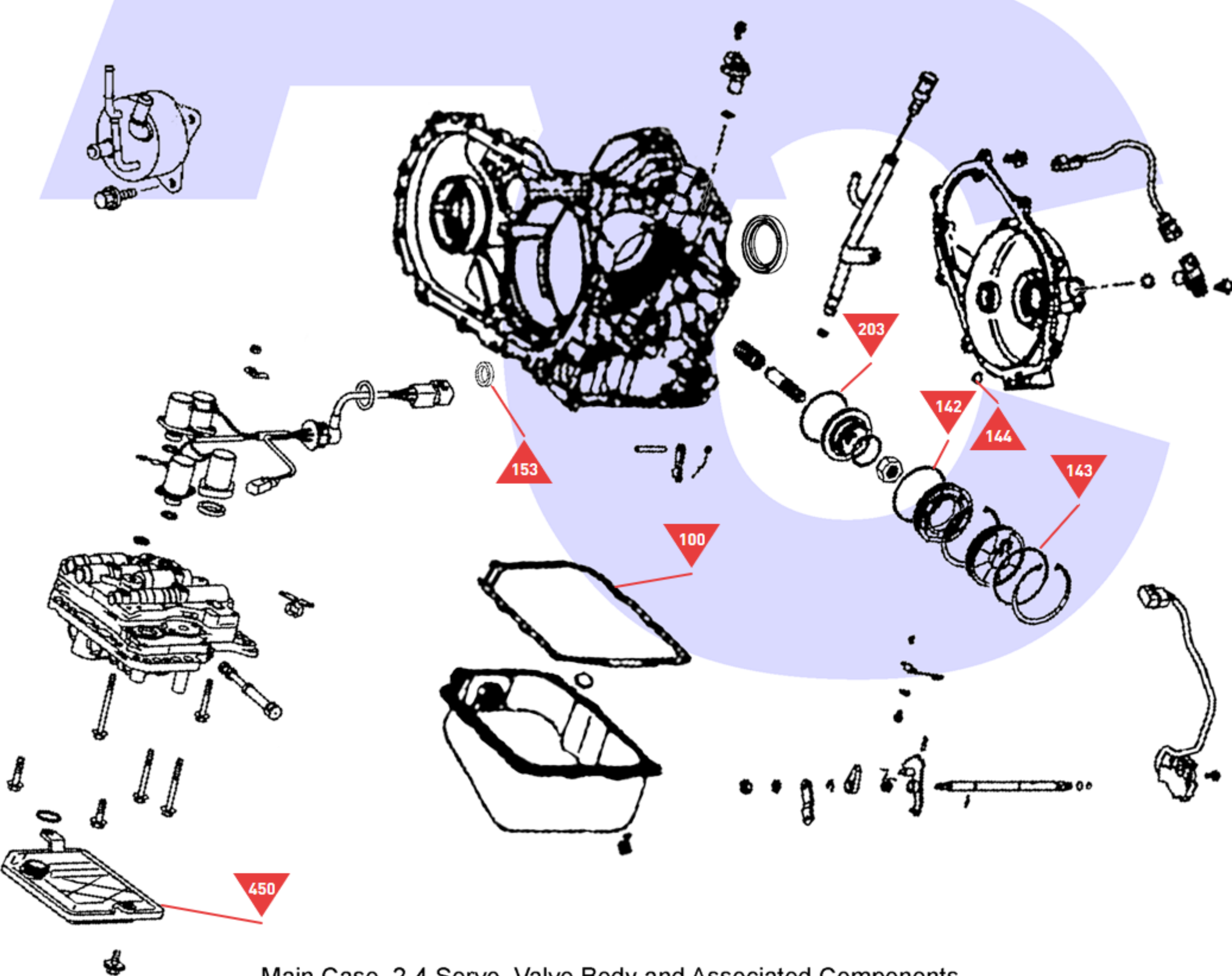

Main Case, 2-4 Servo, Valve Body and Associated Components