

A

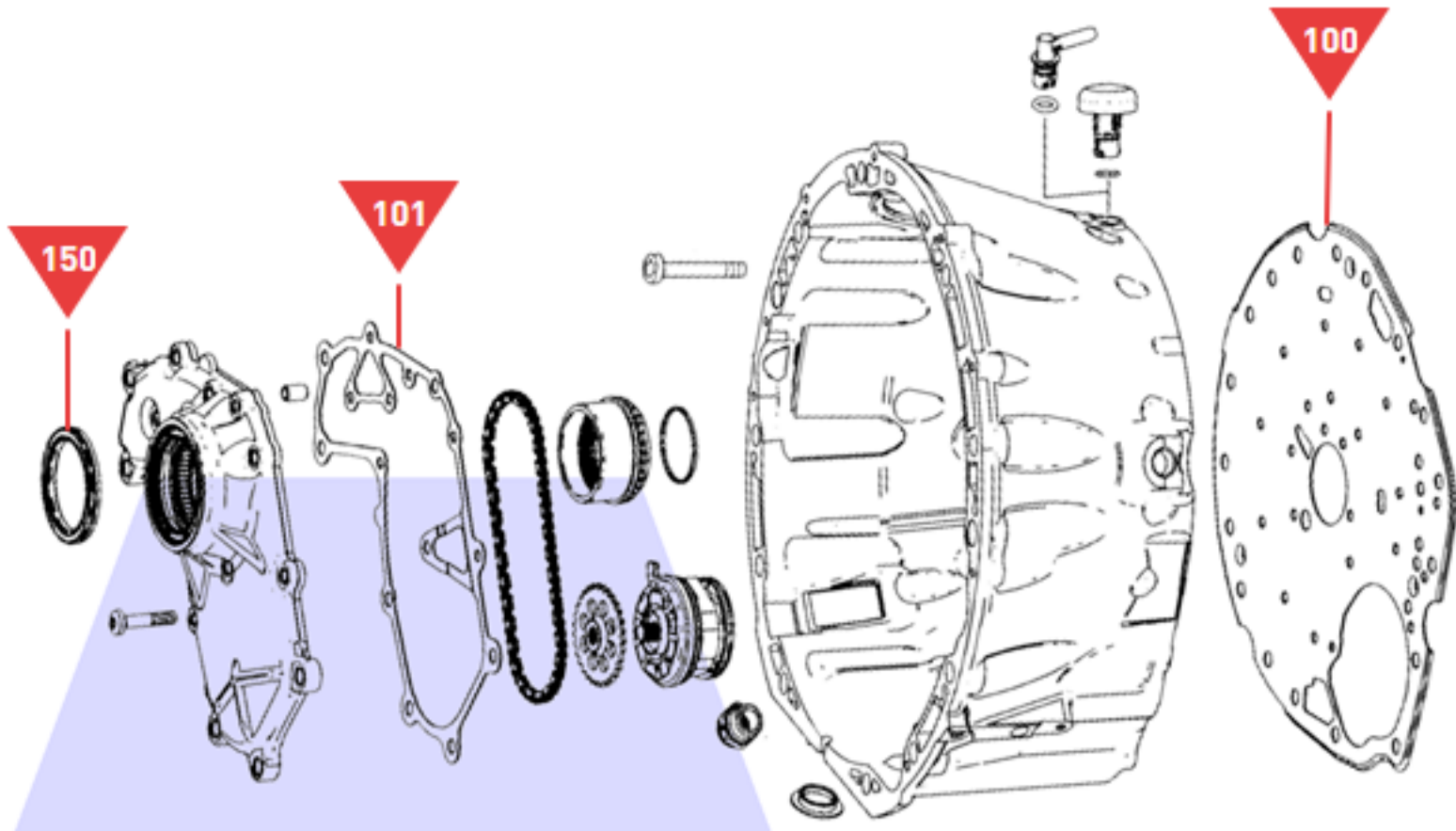

Converter Housing and Oil Pump

B

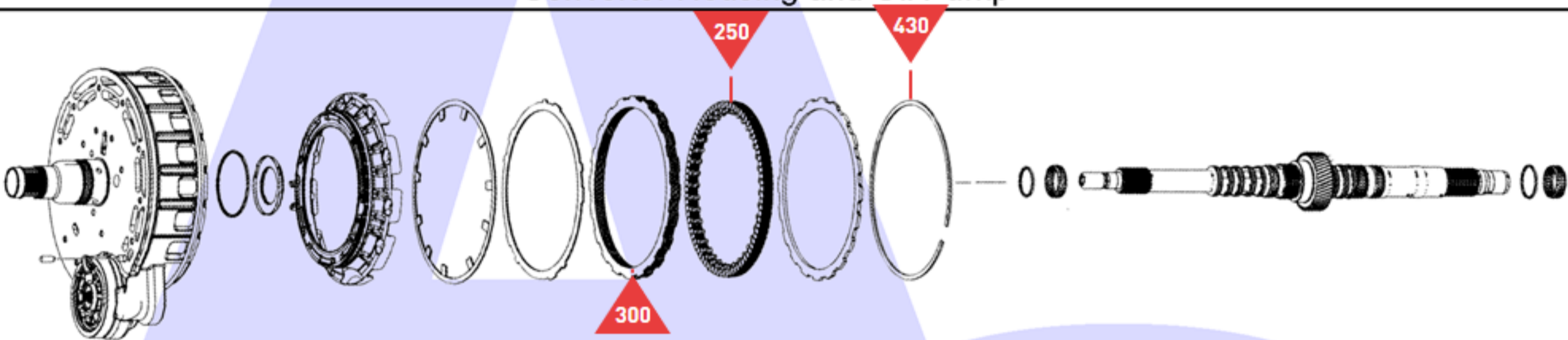

'B08' Brake and Drive Shaft

C

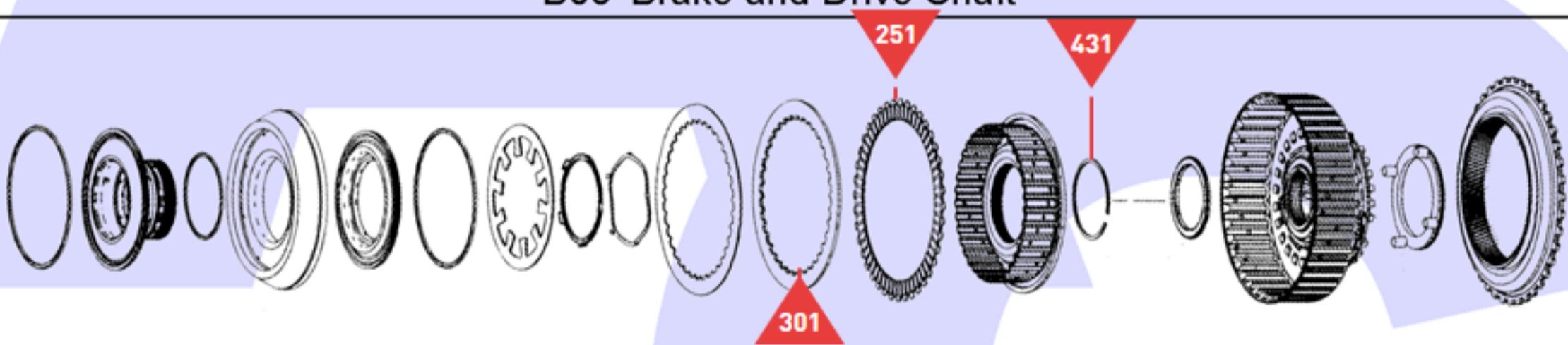

'K81' Clutch and Planetary Gearset No. 1

D

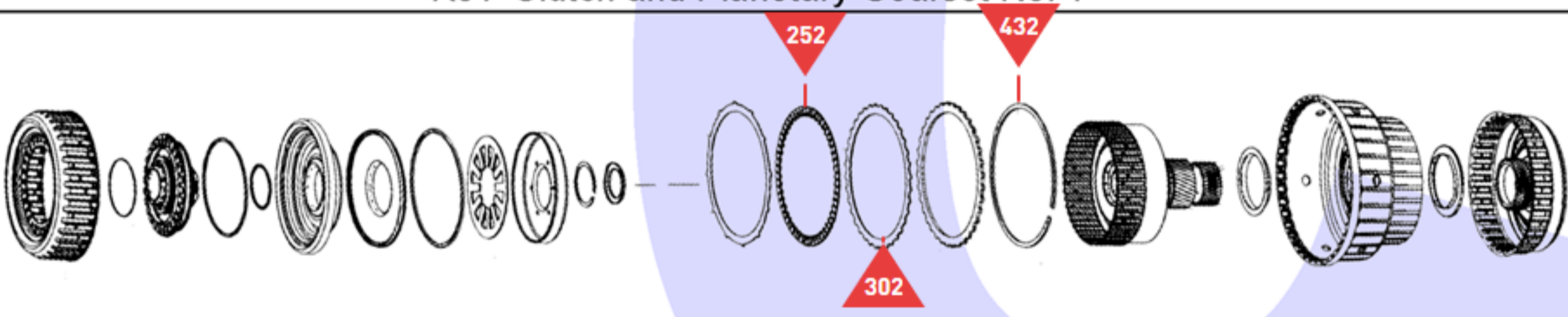

'K38' Clutch and Planetary Gearset No. 2

E

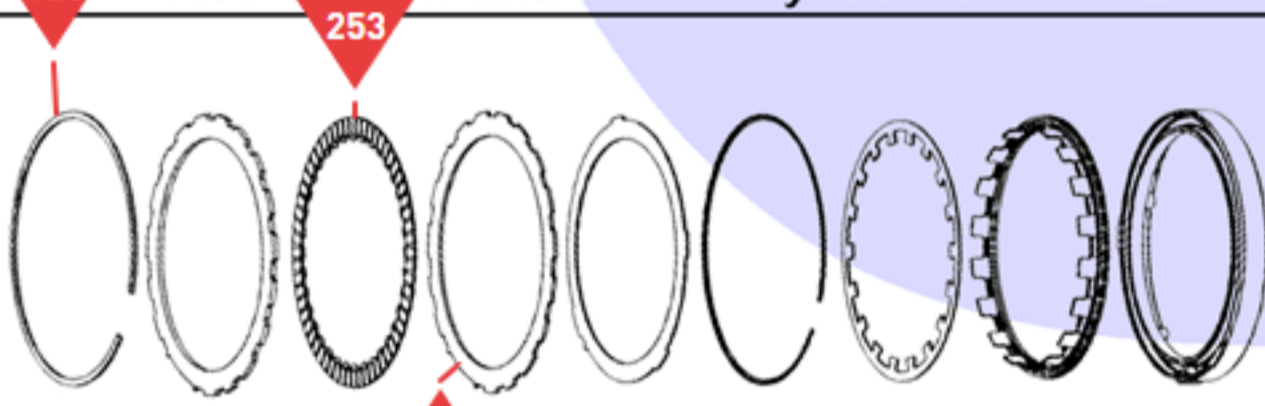

'B05' Brake

F

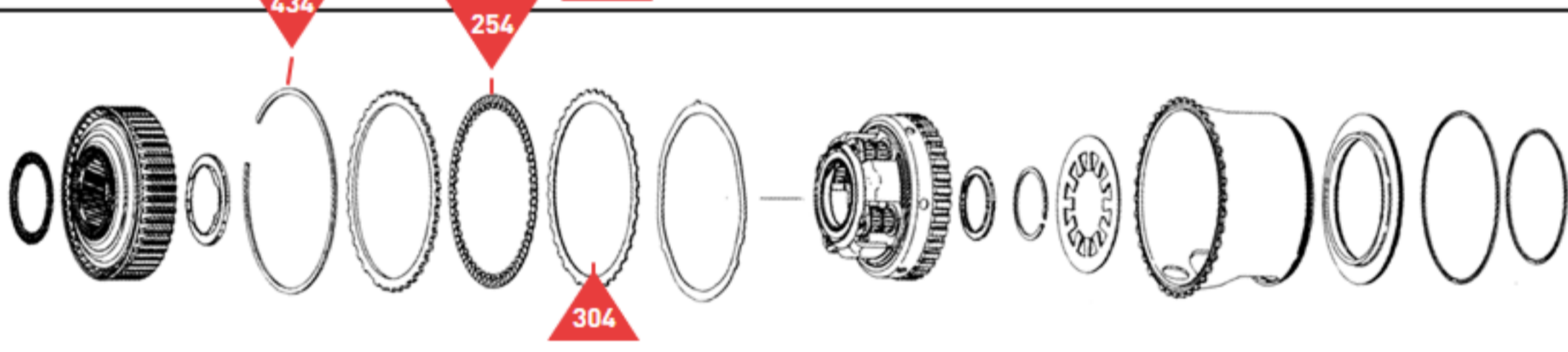

'B06' Brake and Planetary Gearset No. 3

G

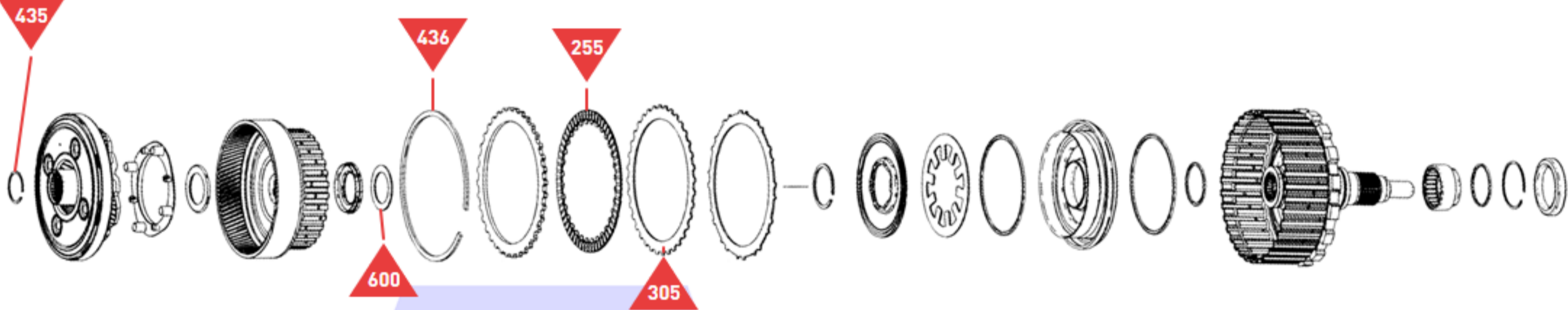

'K27' Clutch and Planetary Gearset No. 4

H

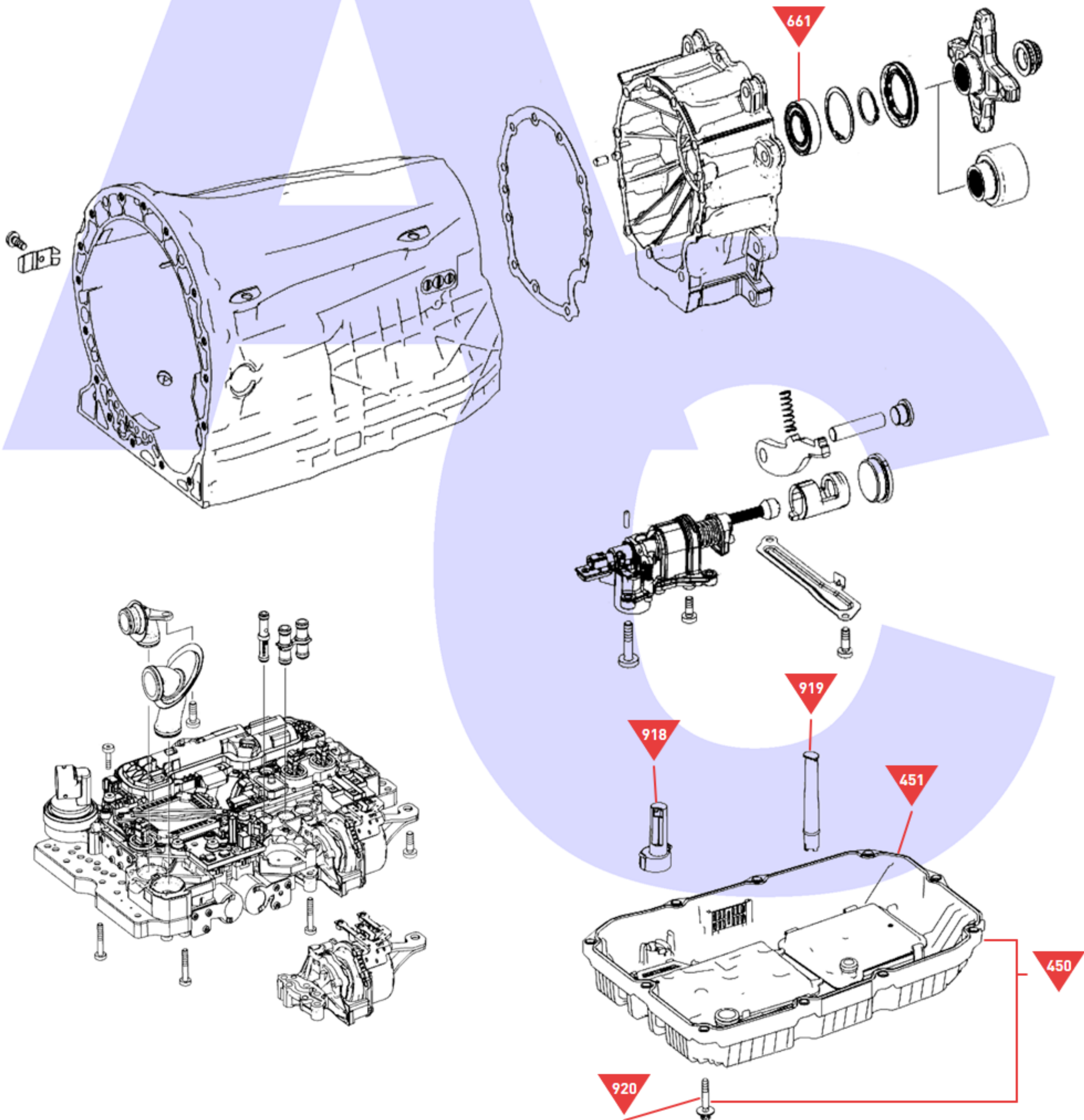

Casing, Output, Mechatronic, External Components, Internal Components, Oil Pan and Filters