

A

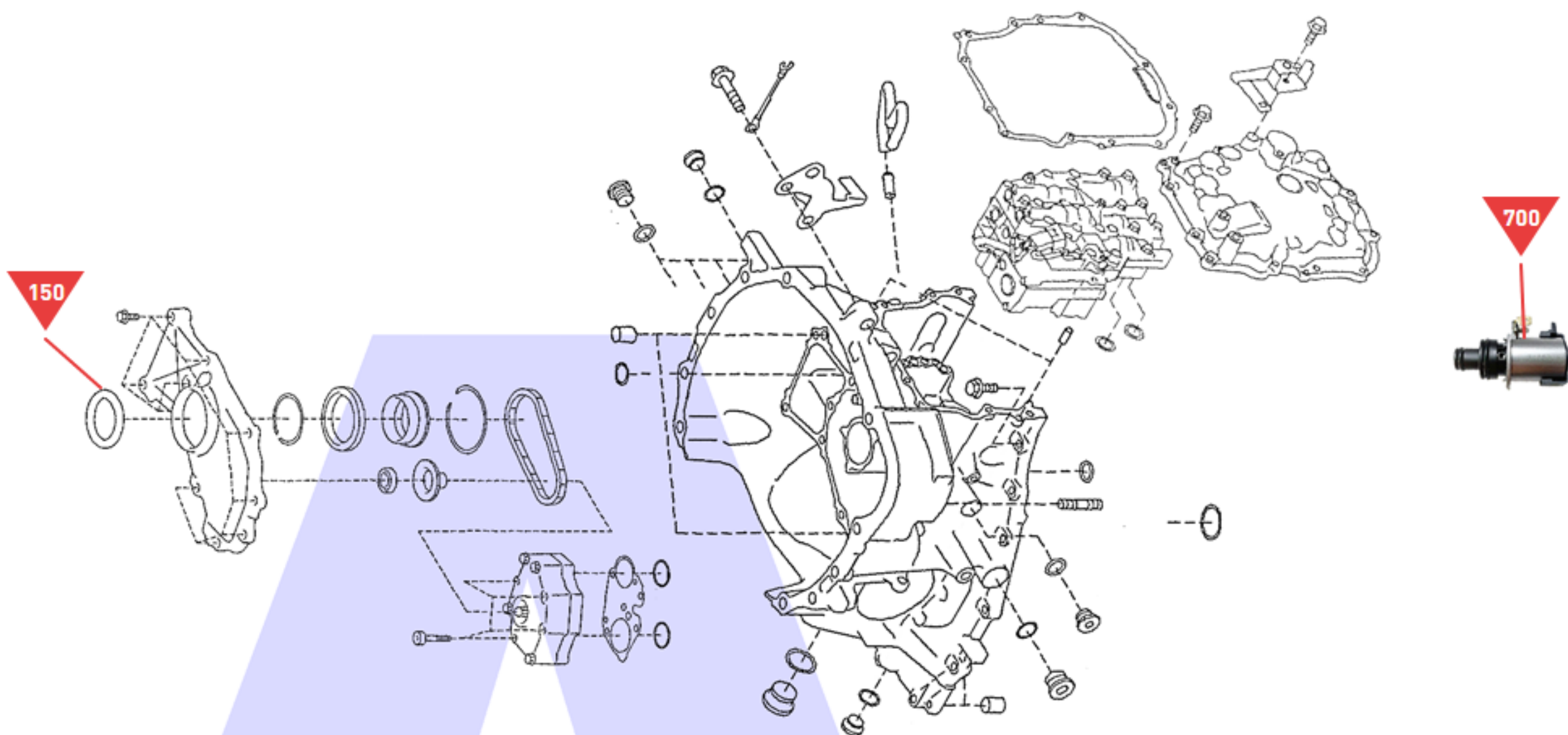

Oil Pump, Bell Housing, Valve Body and External Components

B

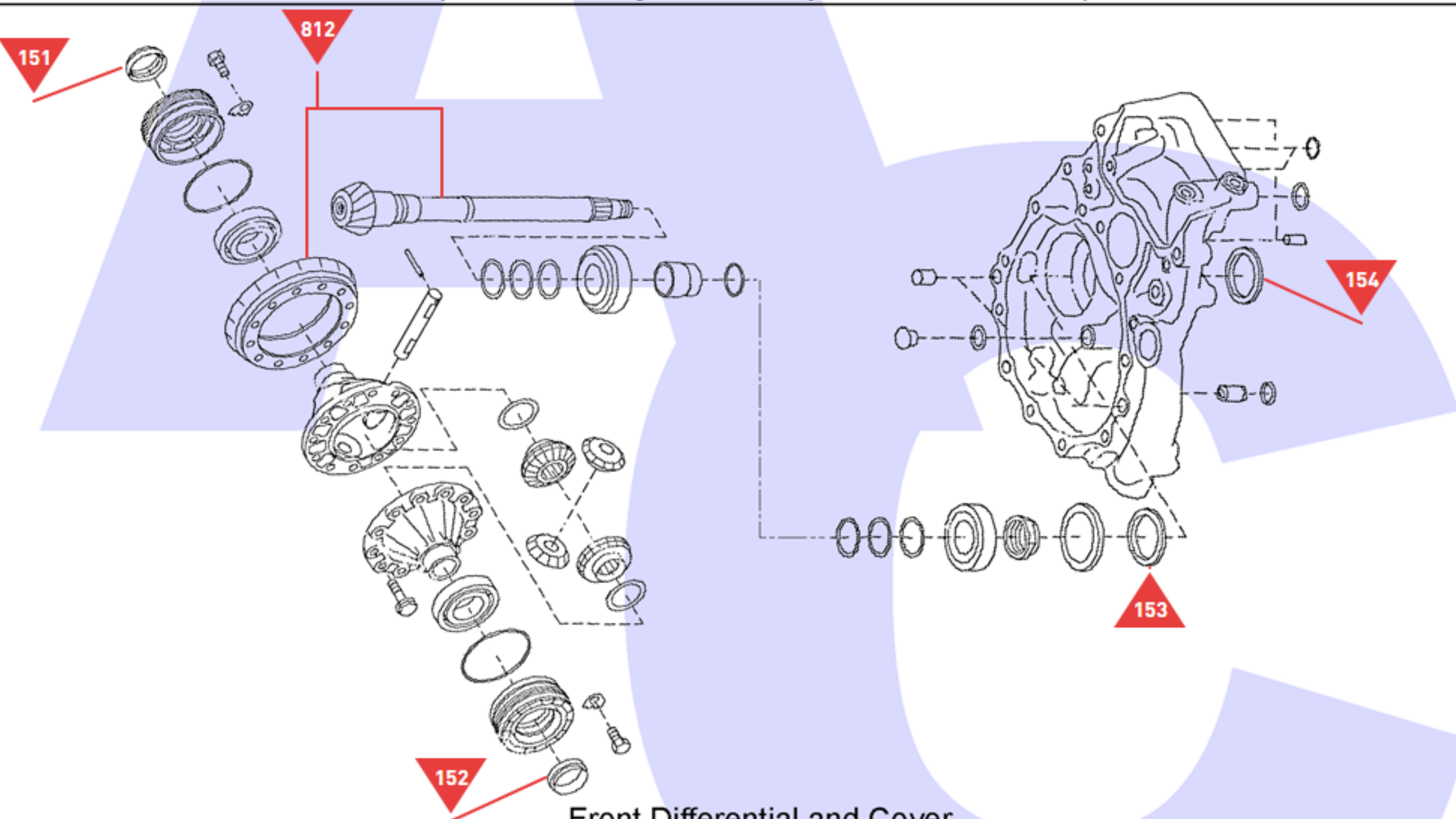

Front Differential and Cover

C

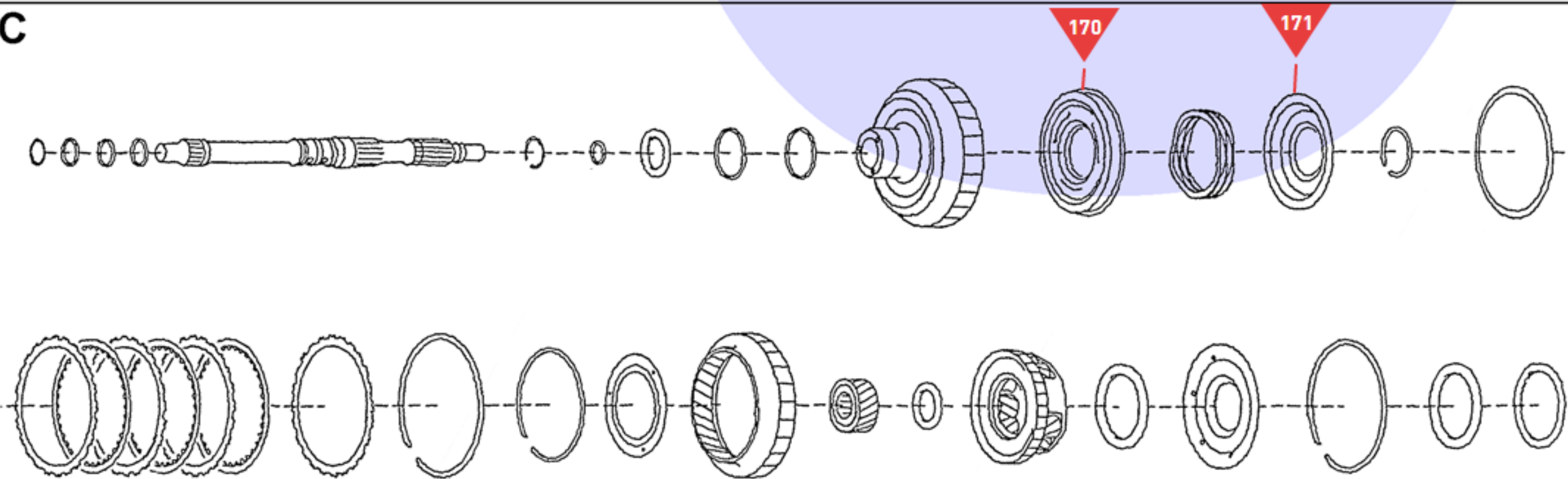

Input Shaft, Forward Clutch and Planetary

D

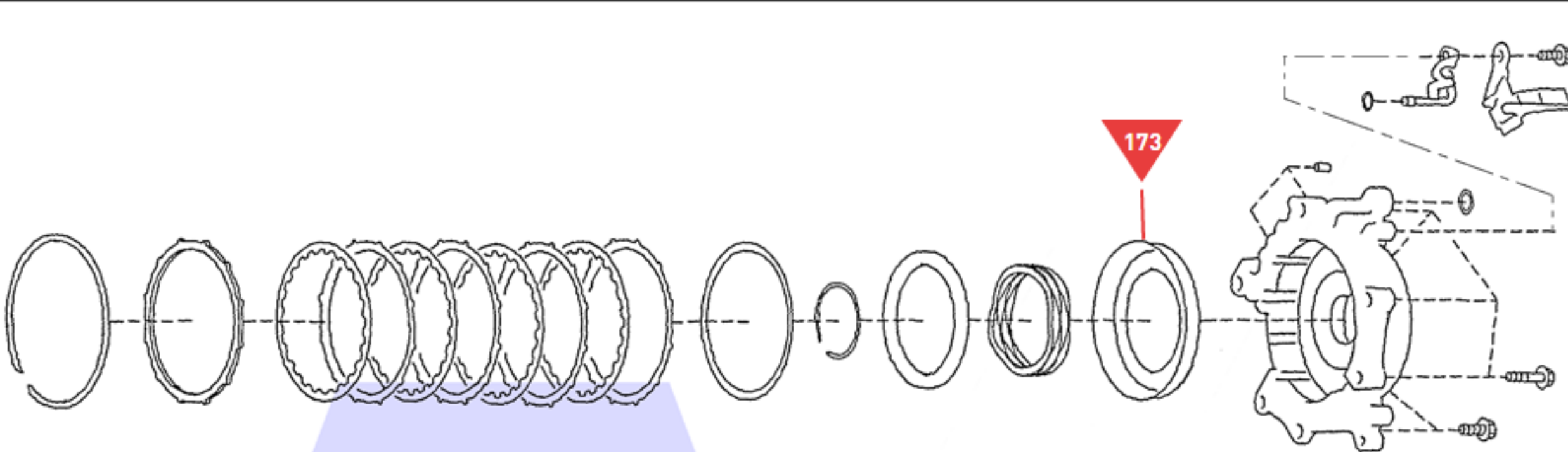

Reverse Brake Assembly

E

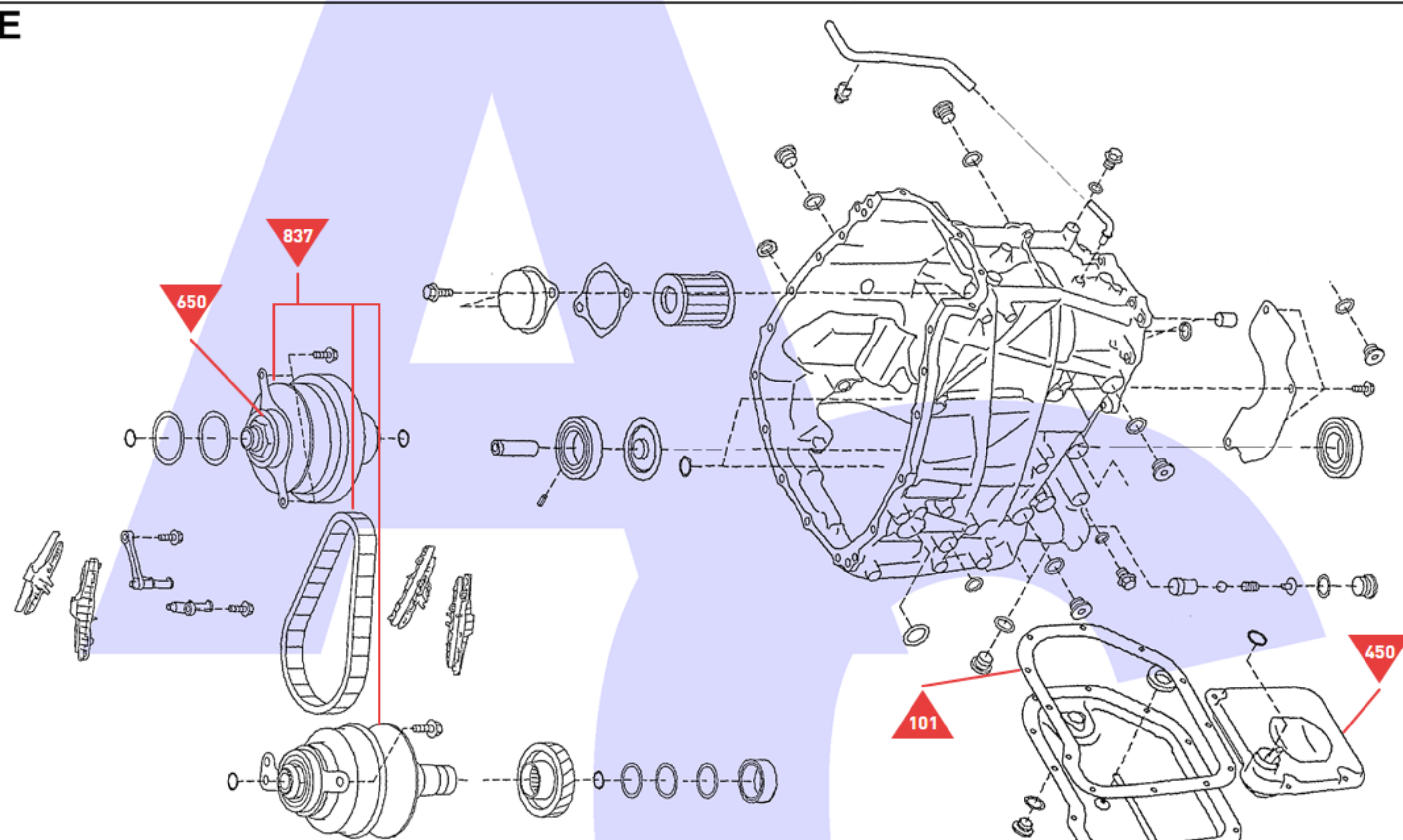

Primary Pulley, Secondary Pulley, Drive Chain, Main Case Etc.

F

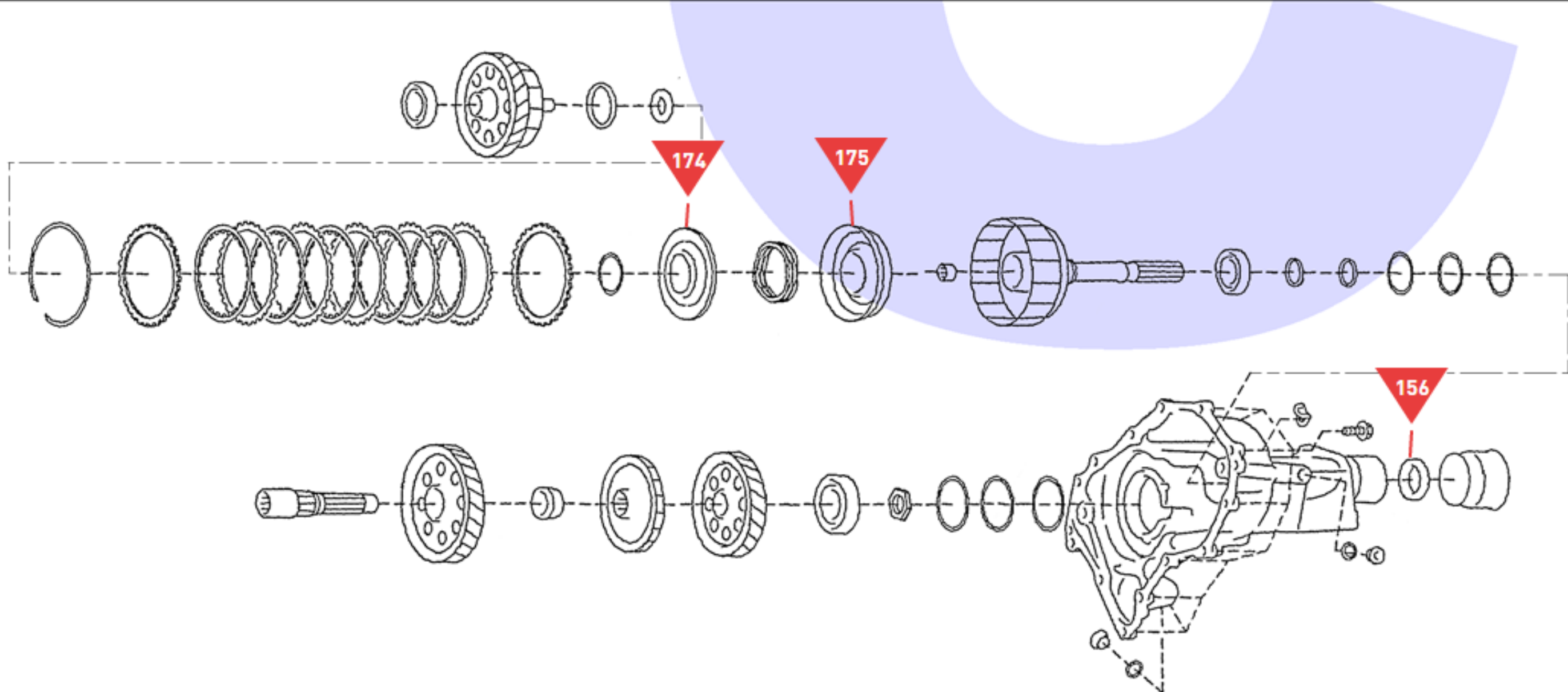

Transfer Gear, Transfer Clutch, Output Clutch and Extension Housing