

A

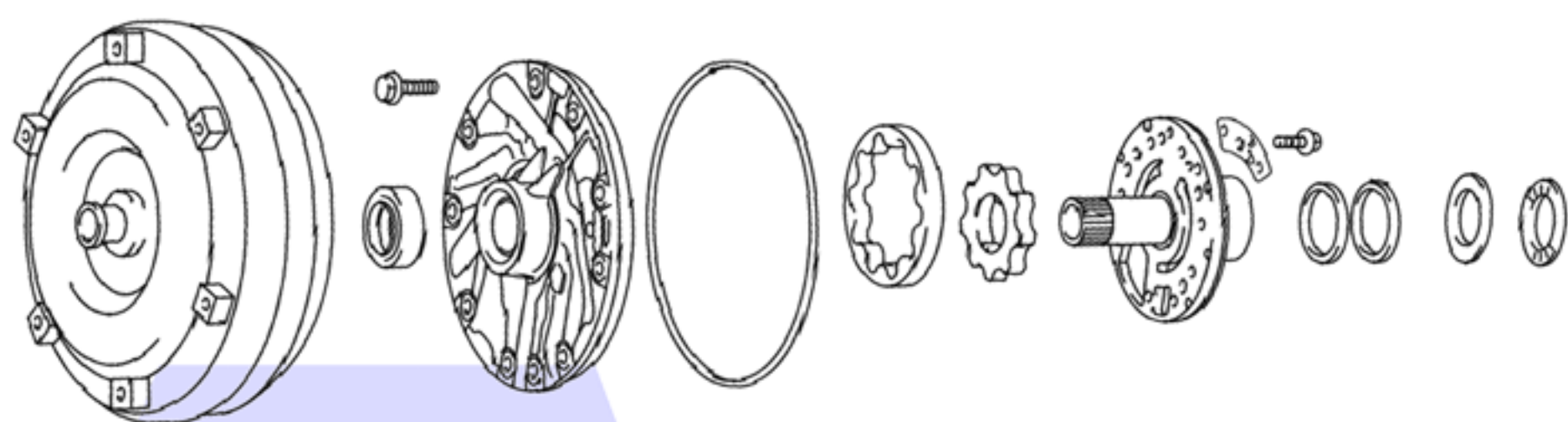

Torque Converter & Oil Pump

B

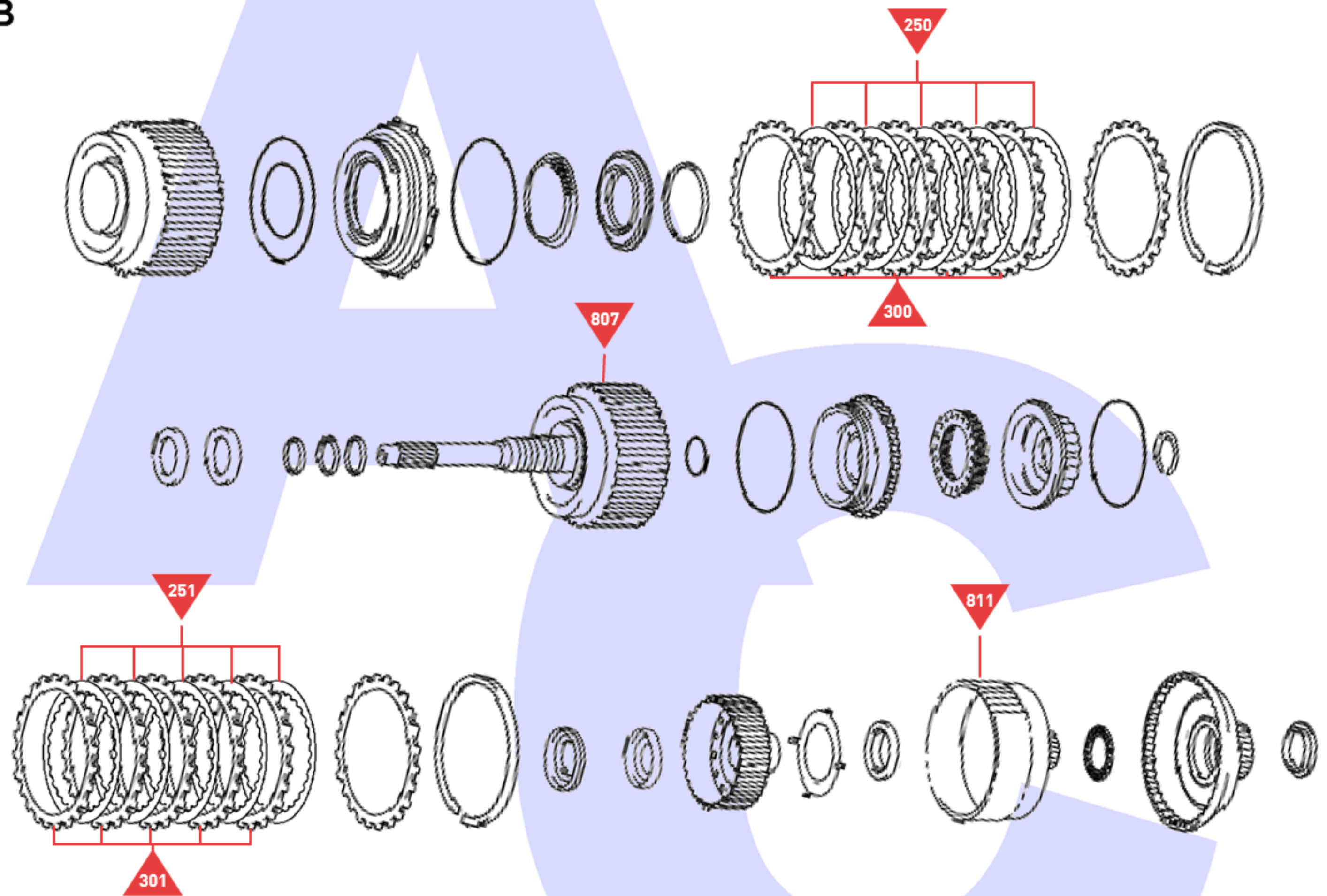

Brake Band, Direct Clutch & Forward Clutch

C

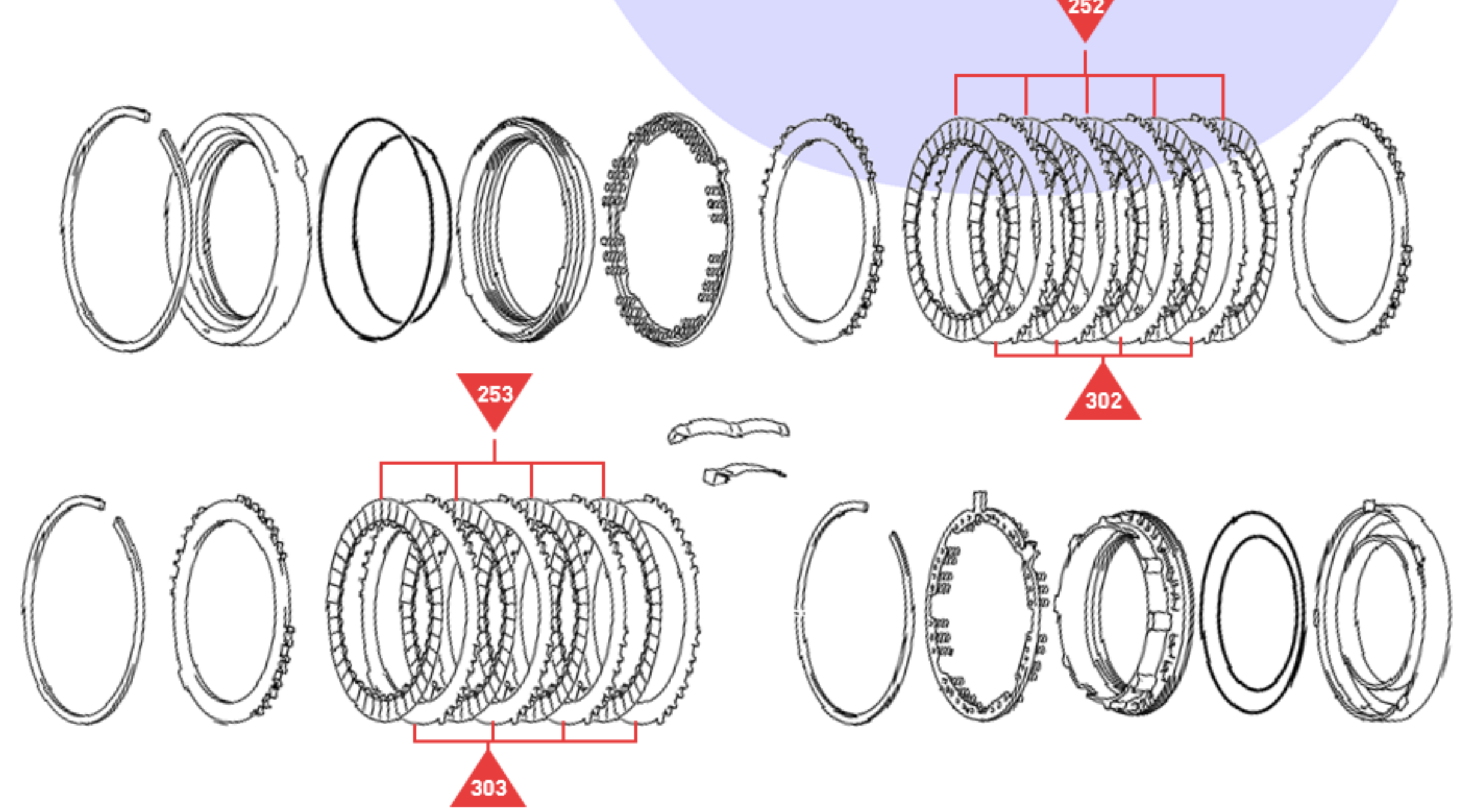

Brake No. 2 & Brake No. 1

D

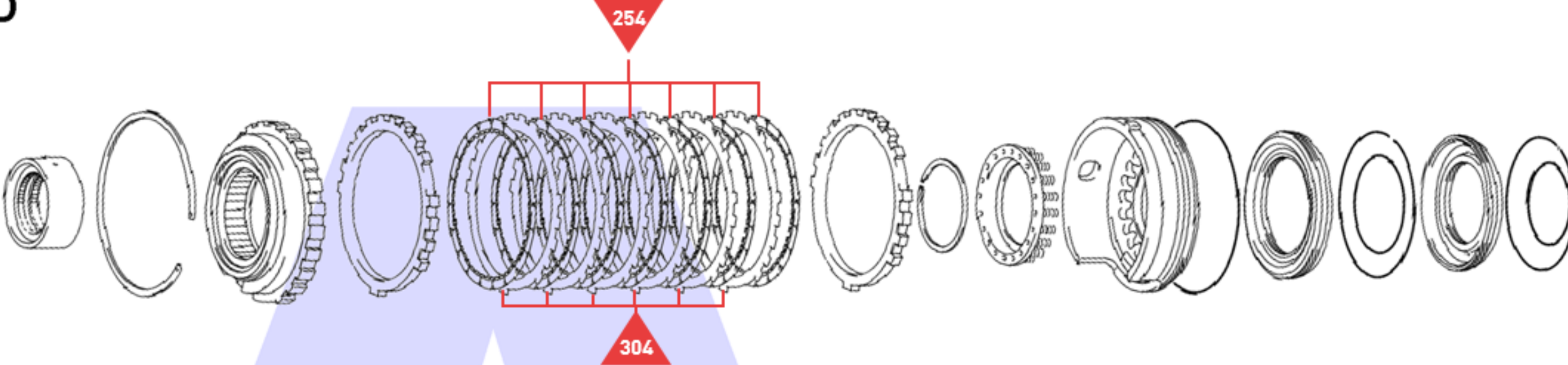

Brake No. 3, 1st & Reverse Brake

E

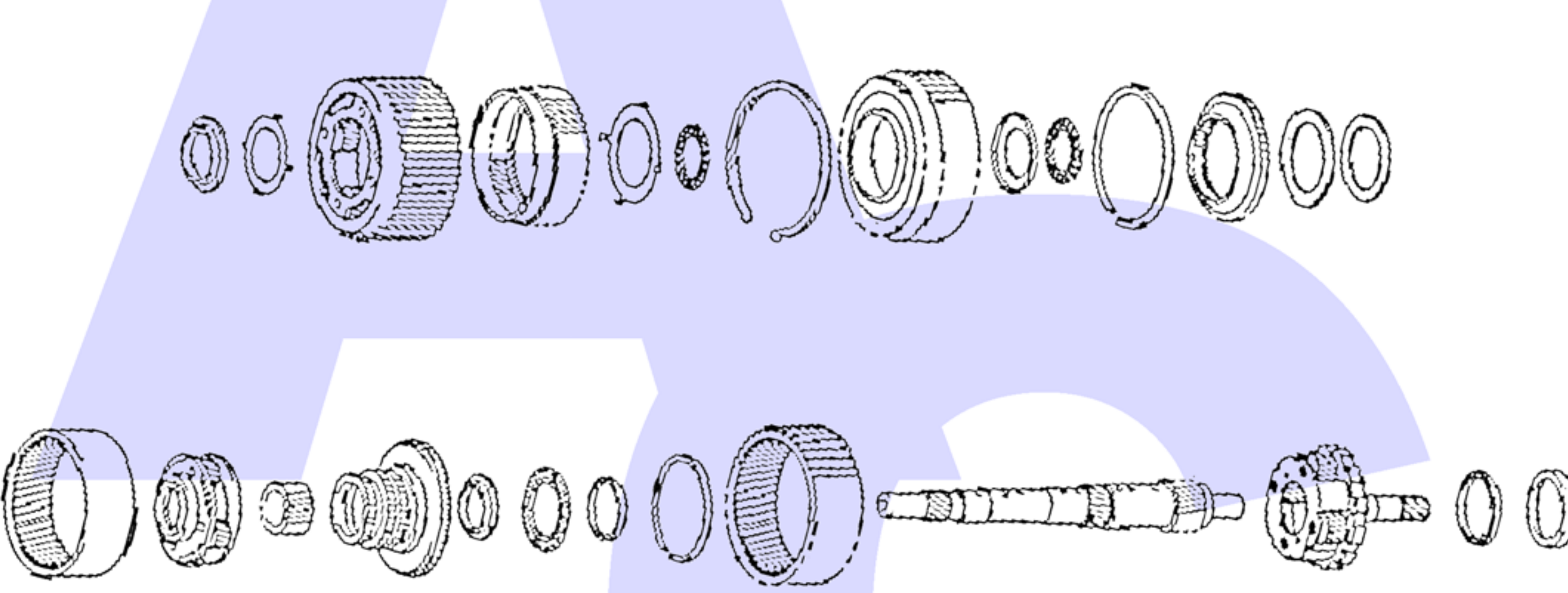

Planetary Gear, Reverse Piston & Counter Gear

F

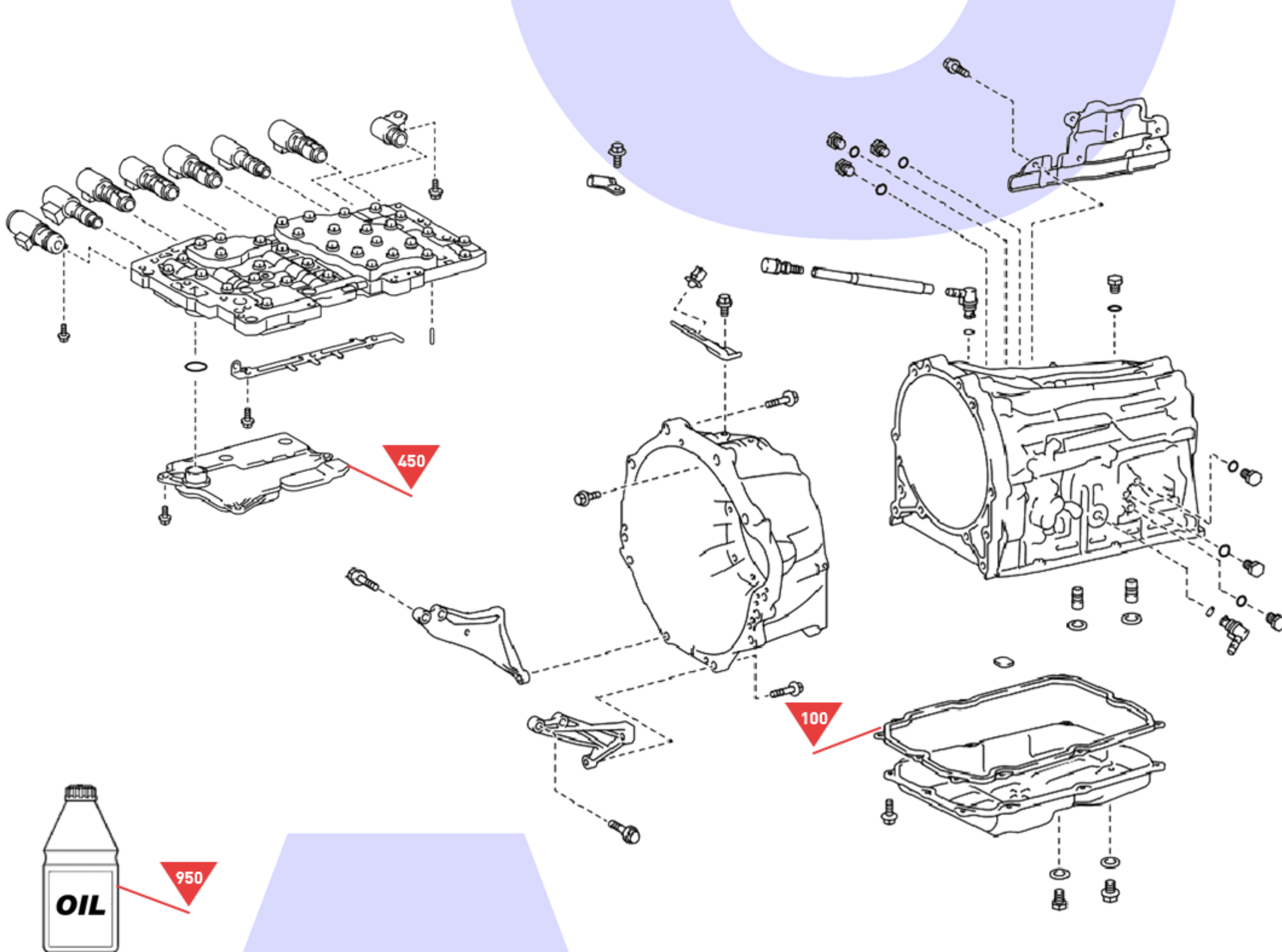

Valve Body, Oil Strainer, Transmission Case & Oil Pan