

A

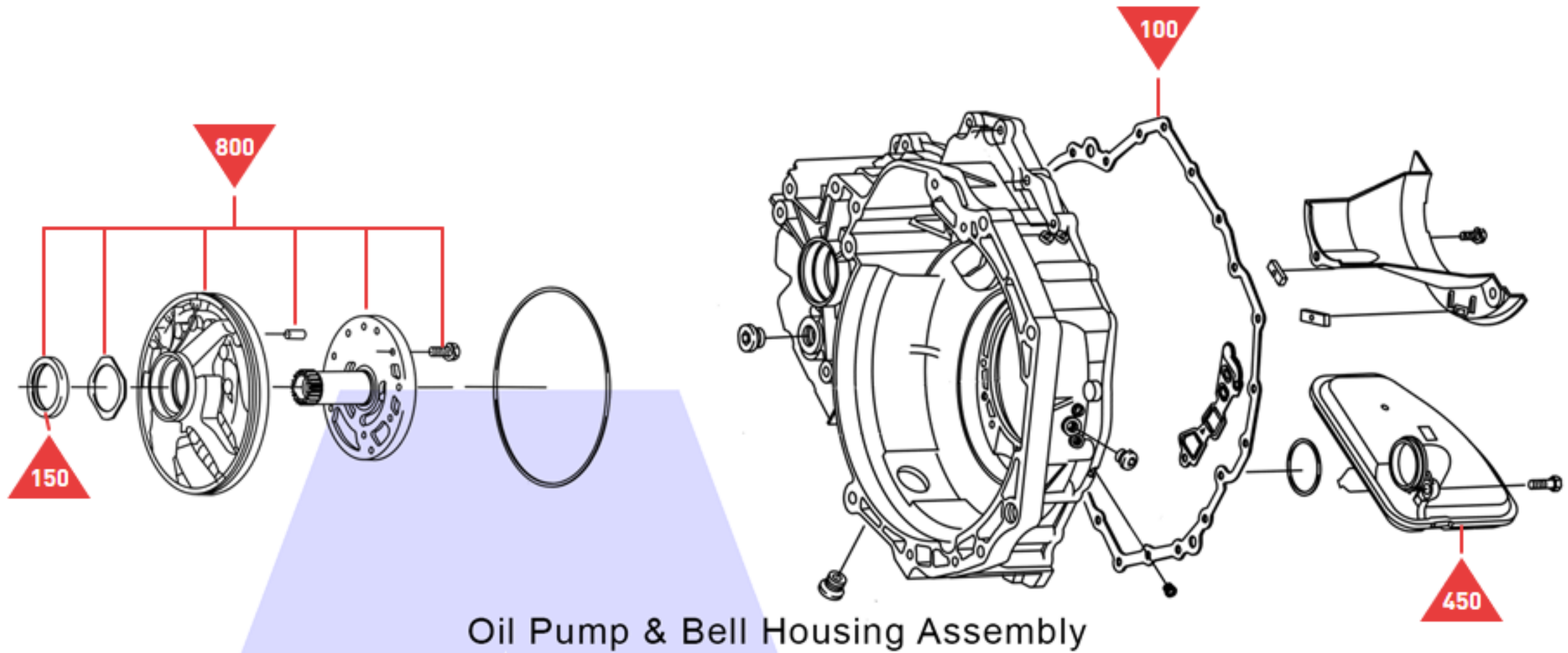

Oil Pump & Bell Housing Assembly

B

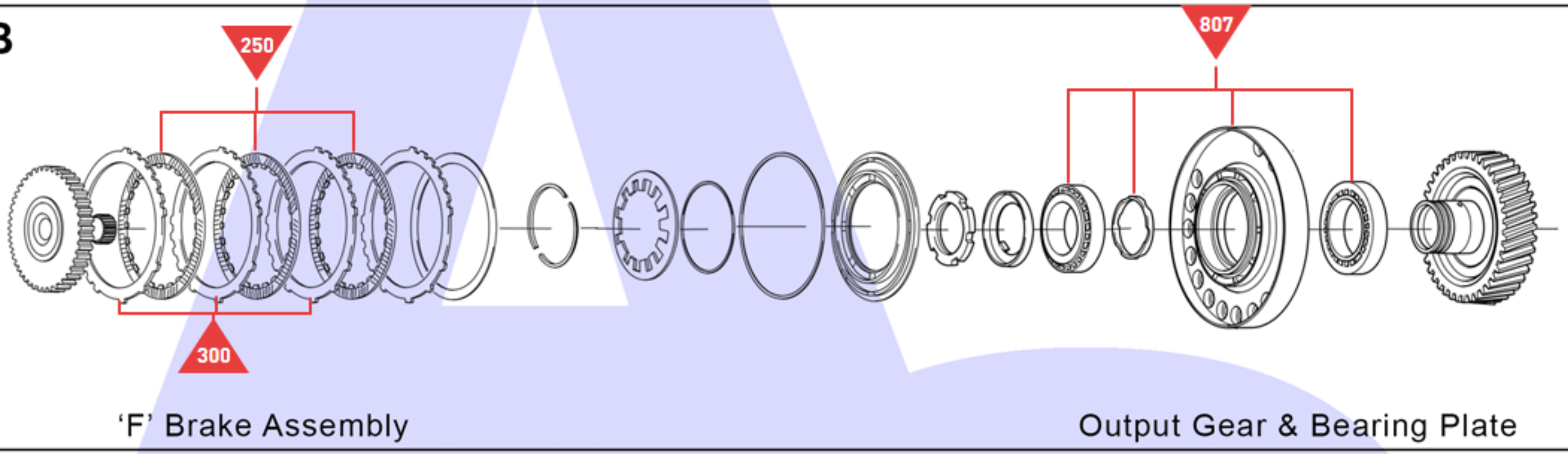

'F' Brake Assembly

Output Gear & Bearing Plate

C

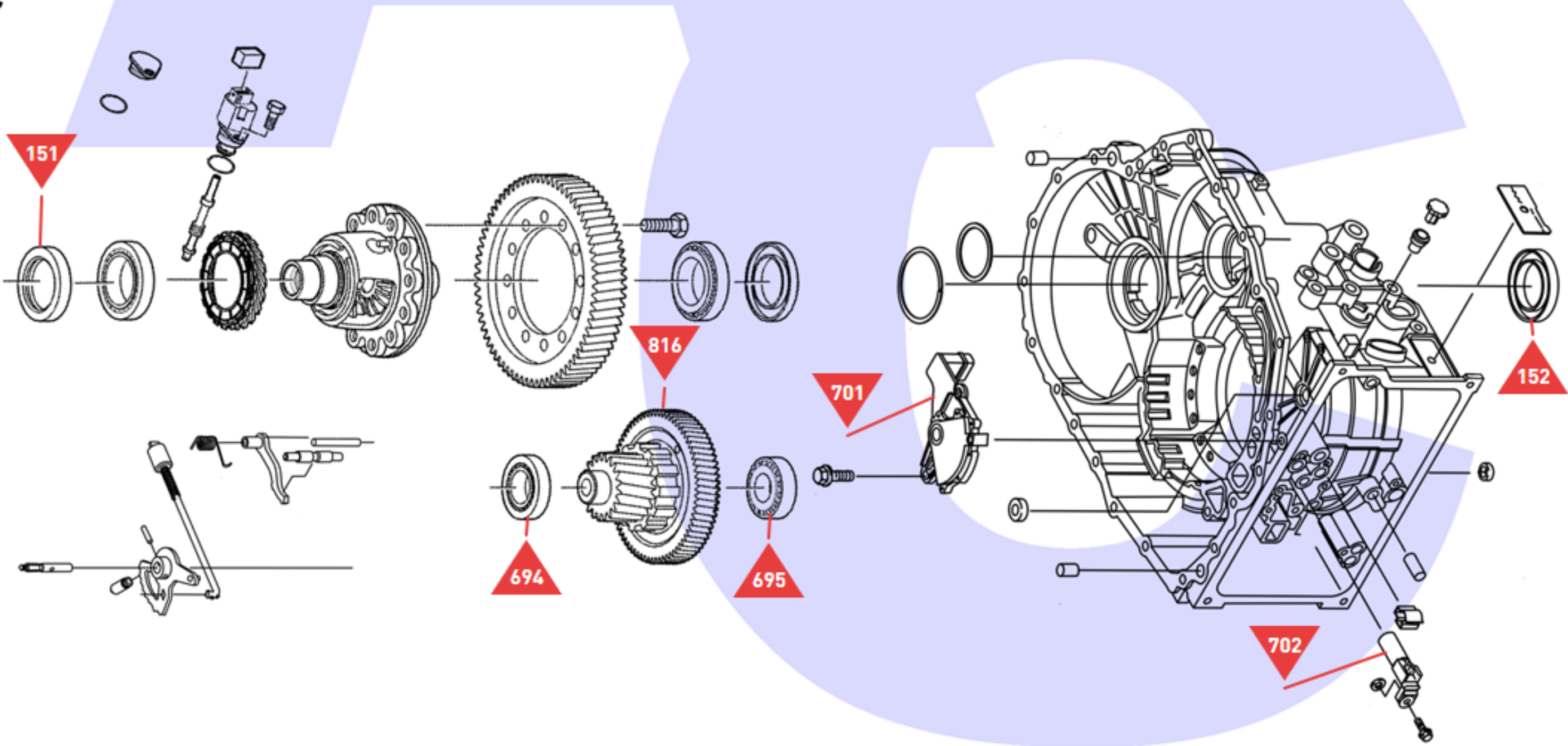

Differential, Main Case & Components

D

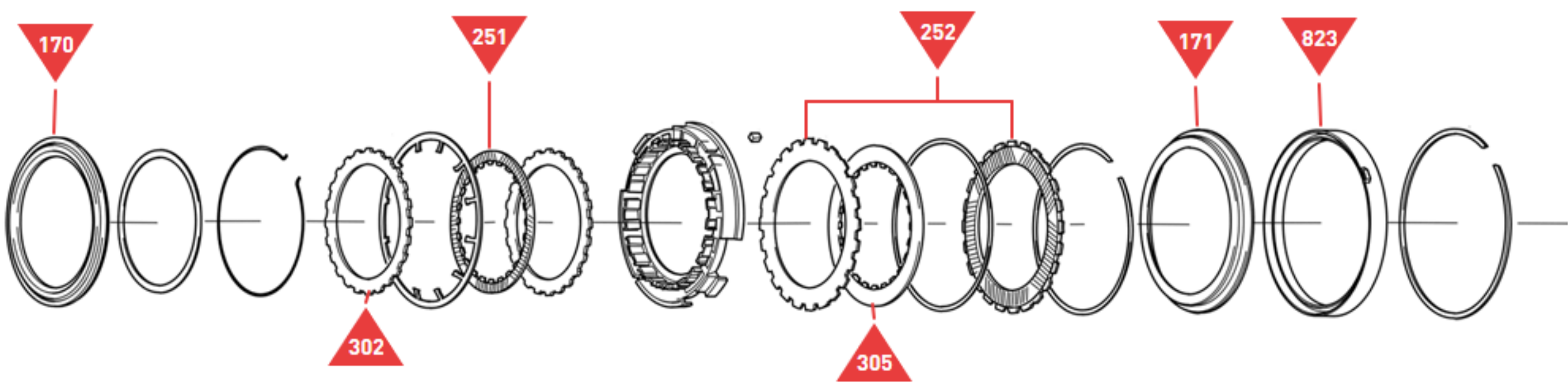

'D' Brake Assembly

'C' Brake Assembly

E

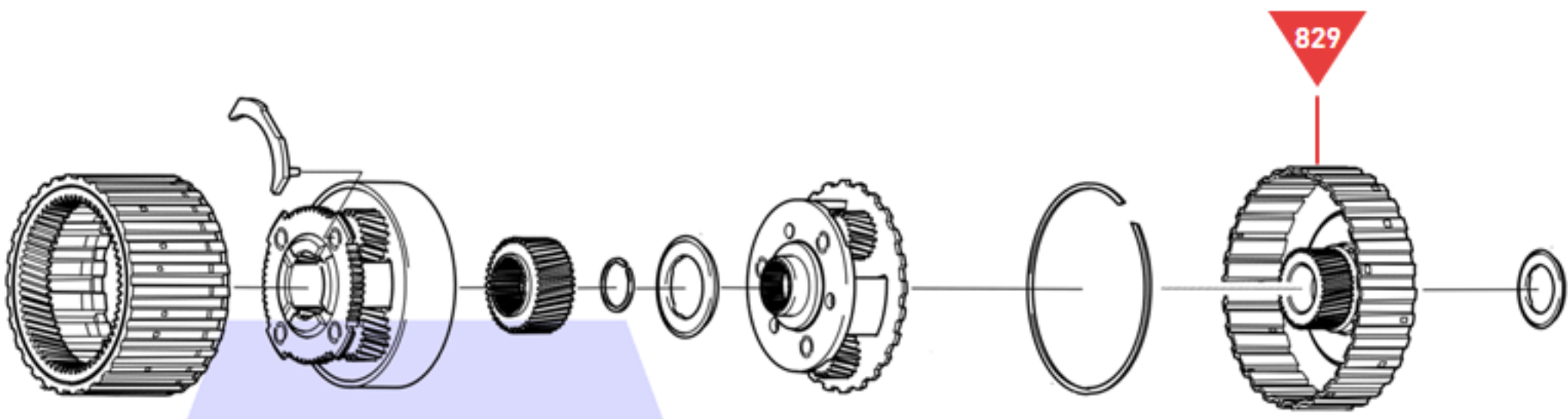

Front & Rear Planetary Assembly

F

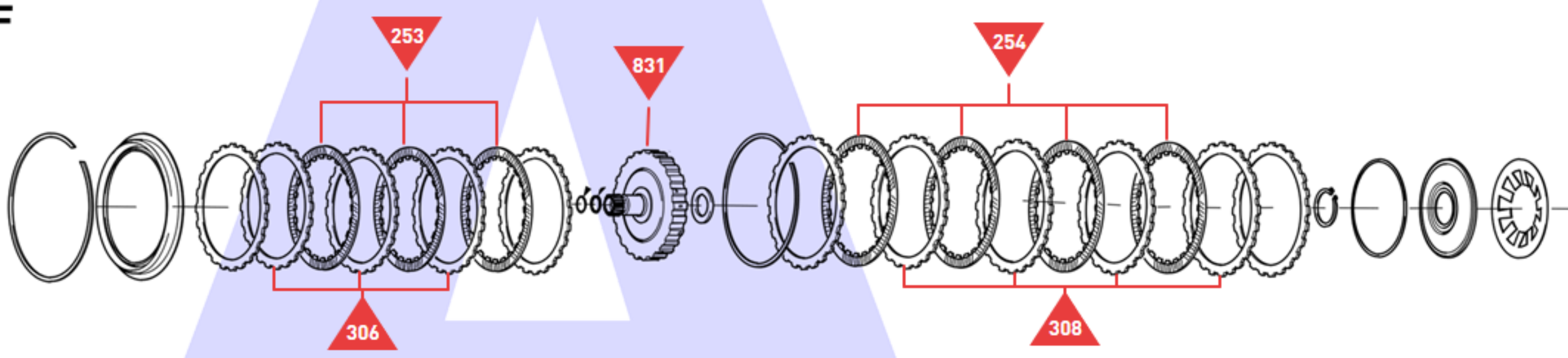

'B' Clutch Assembly

'E' Clutch Assembly

G

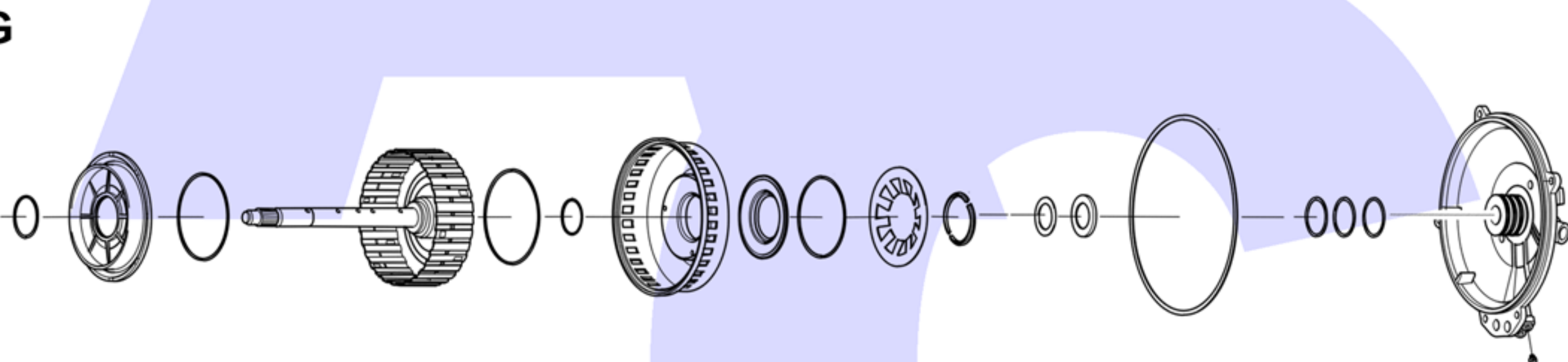

'B' & 'E' Clutch Carriers & End Cover

H

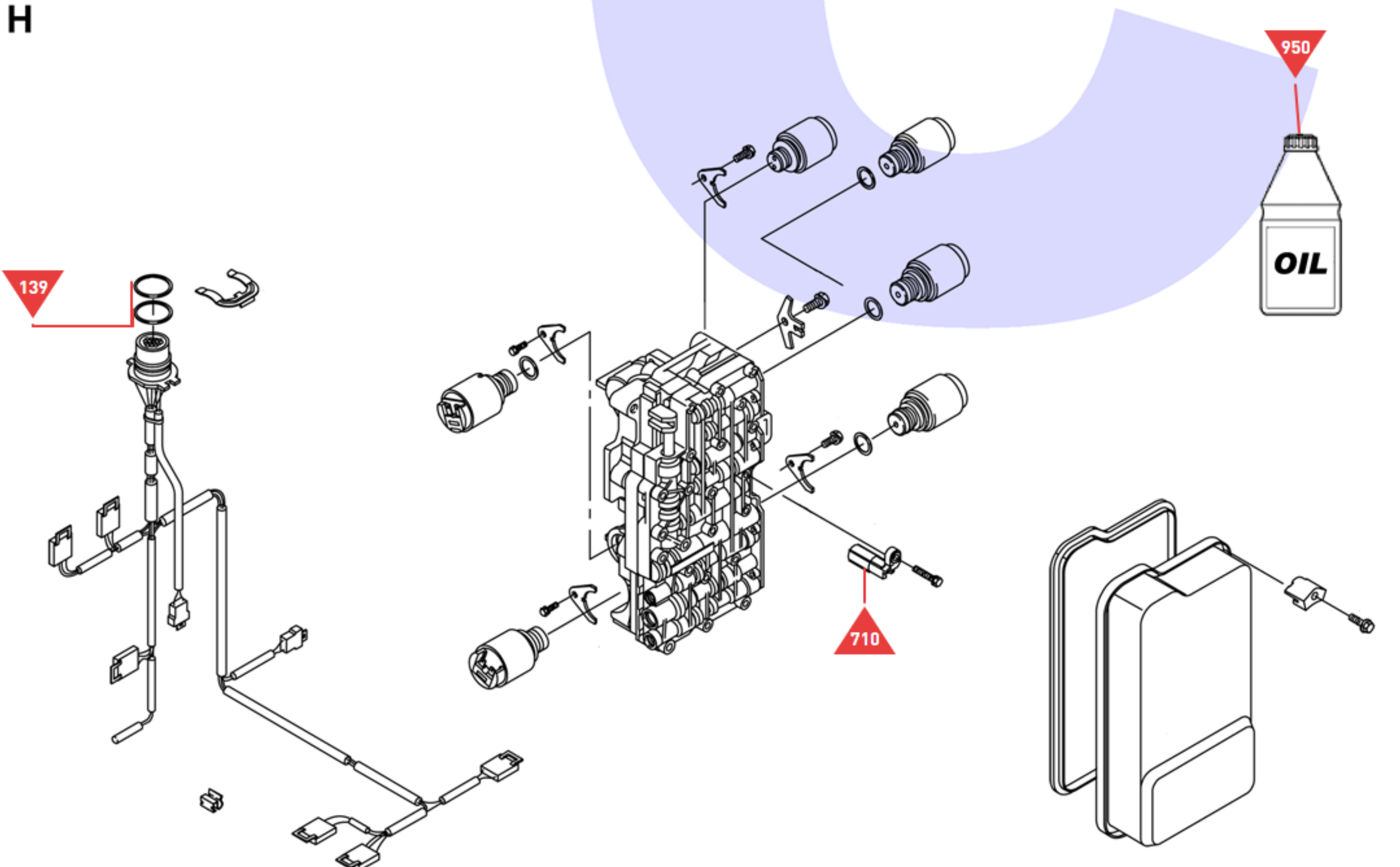

Valve Body and Associated Components