

A

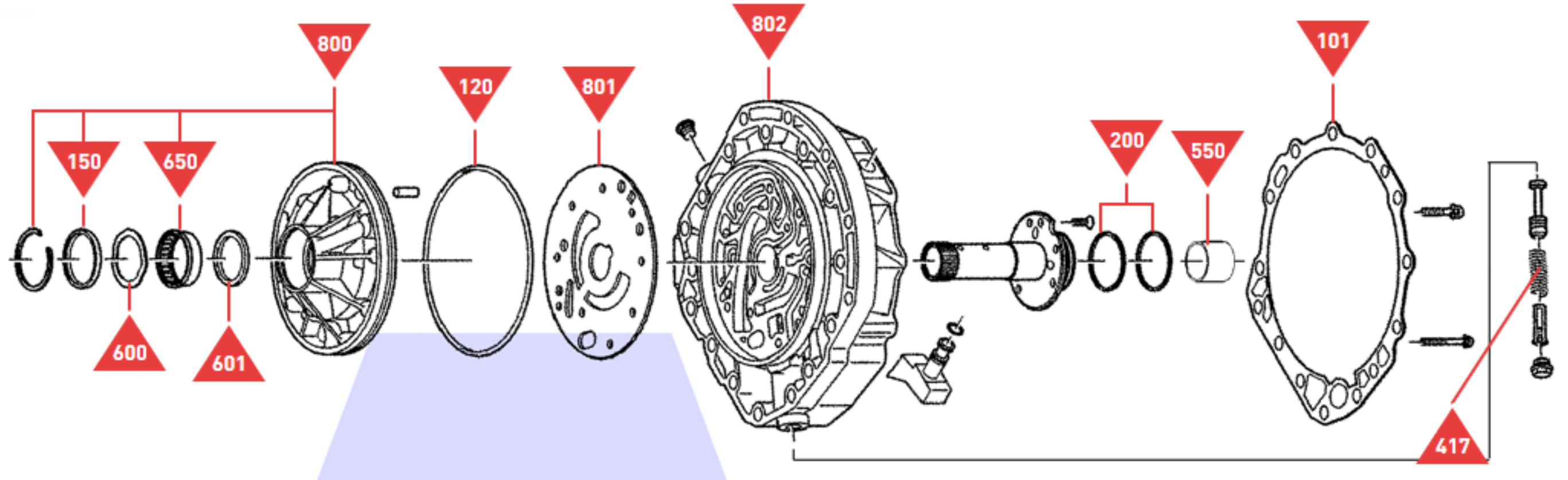

Oil Pump Assy

B

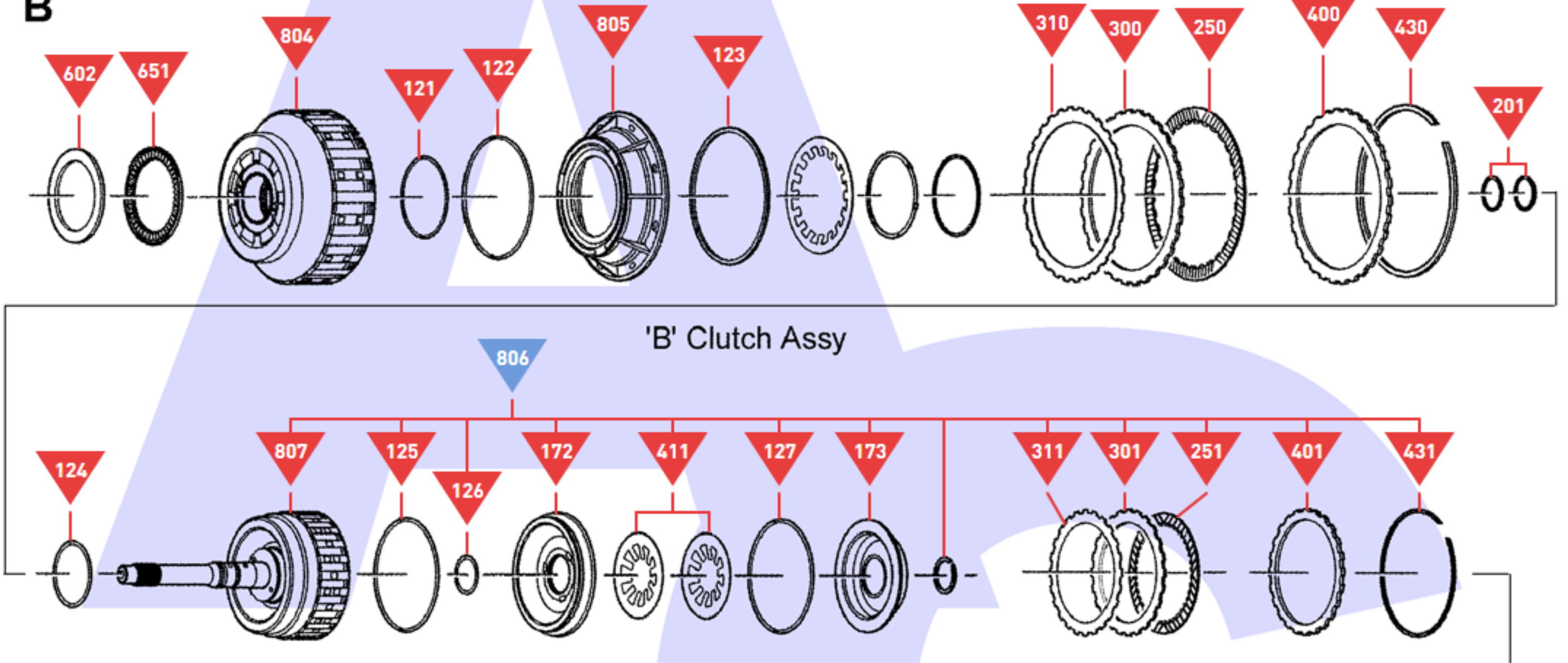

'B' Clutch Assy

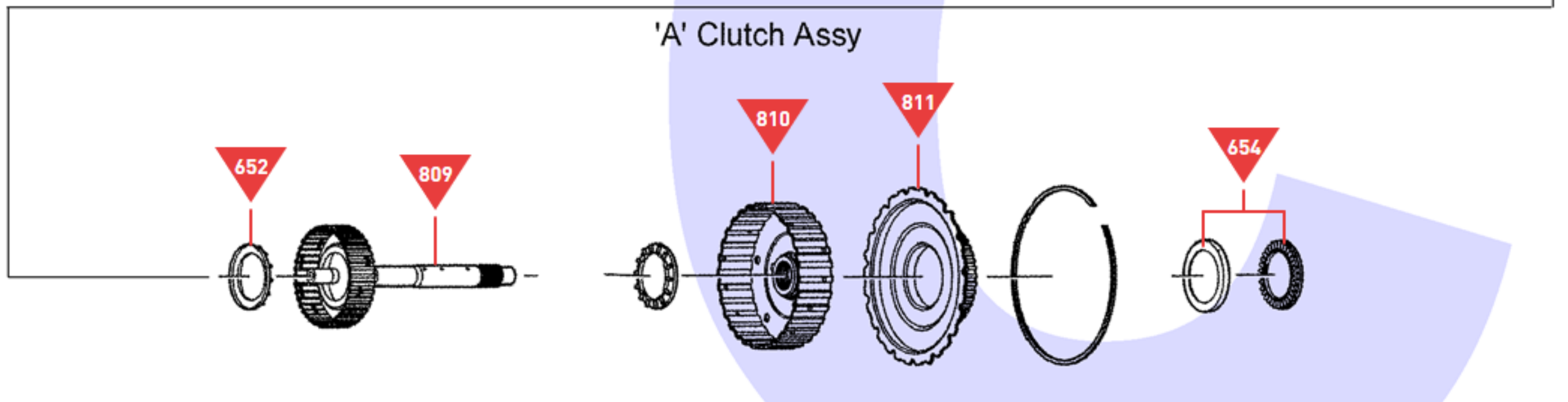

Rear of 'B' Clutch Assy

C

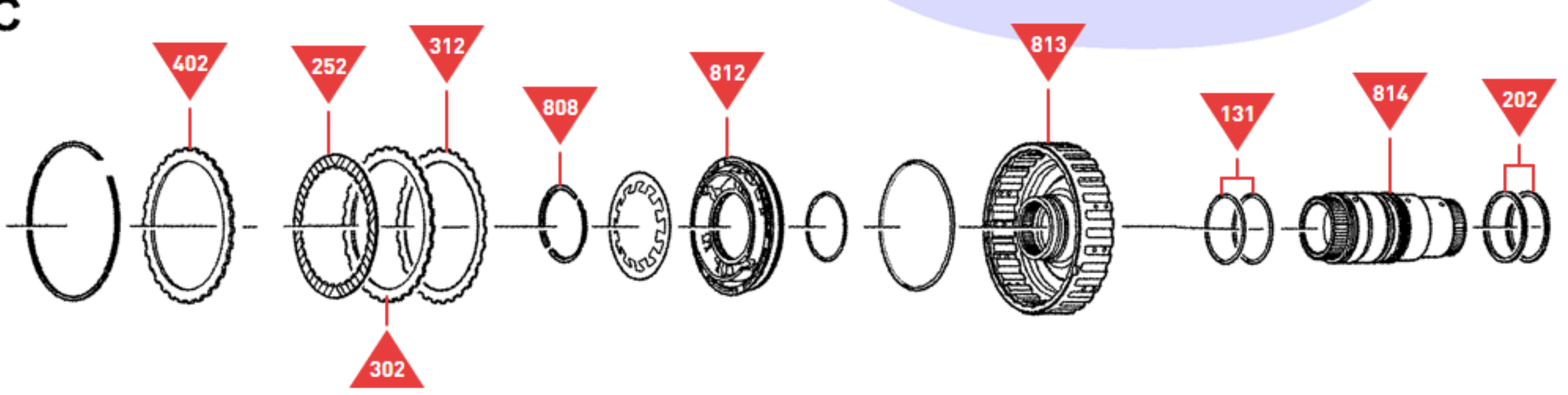

'C' Clutch Assy

D

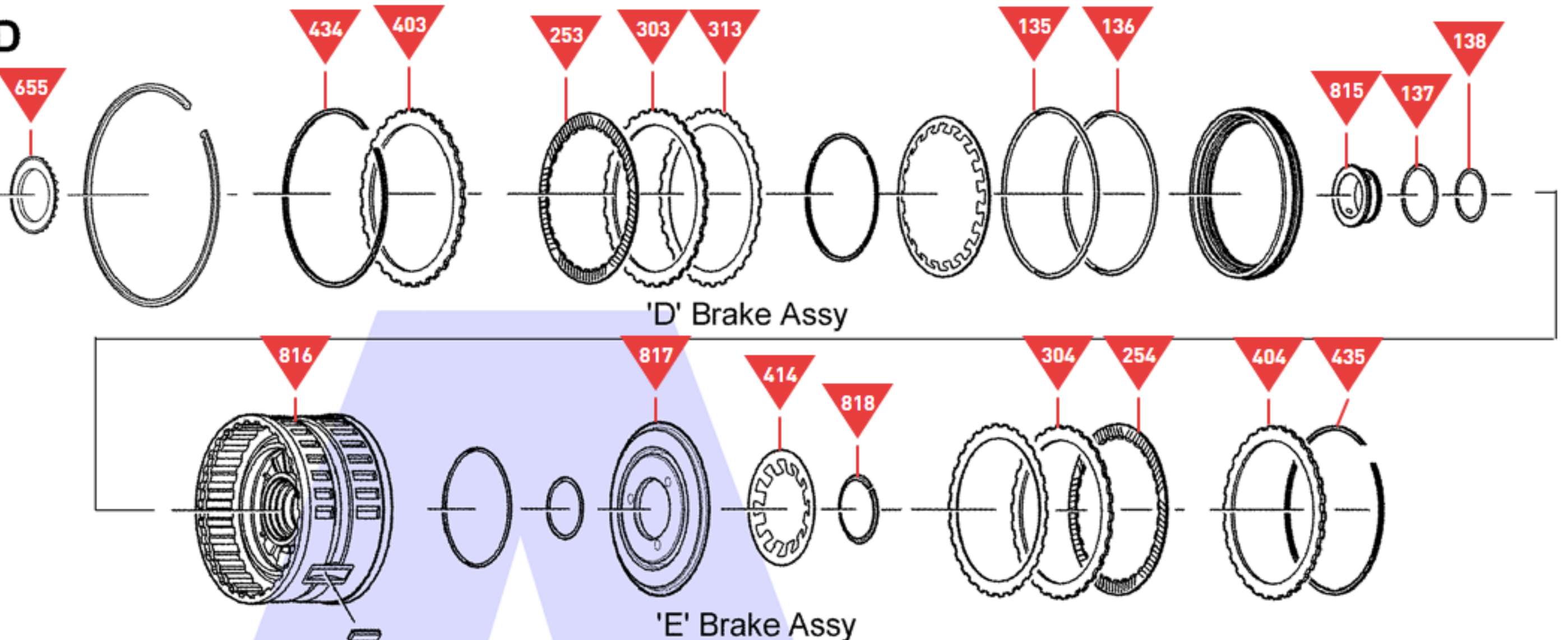

'D' Brake Assy

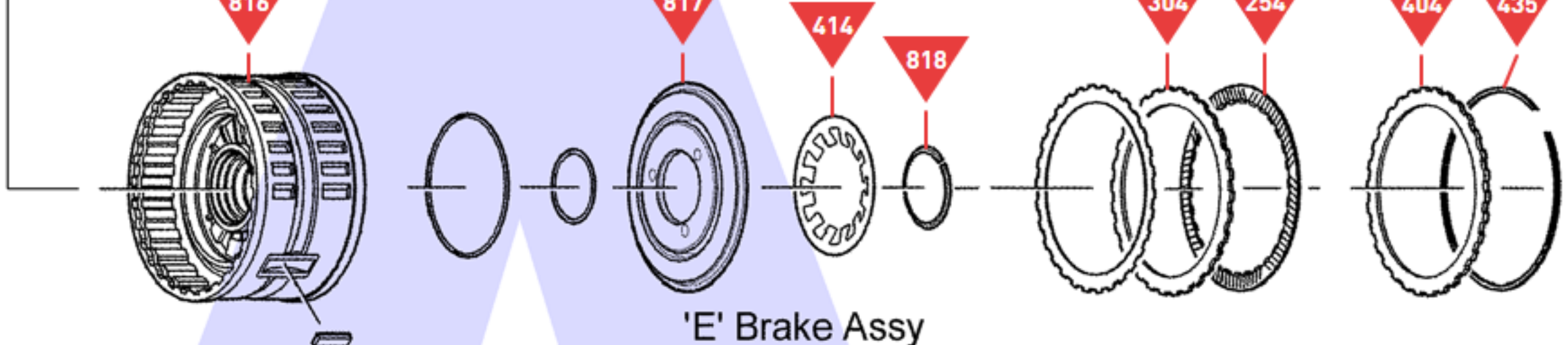

'E' Brake Assy

E

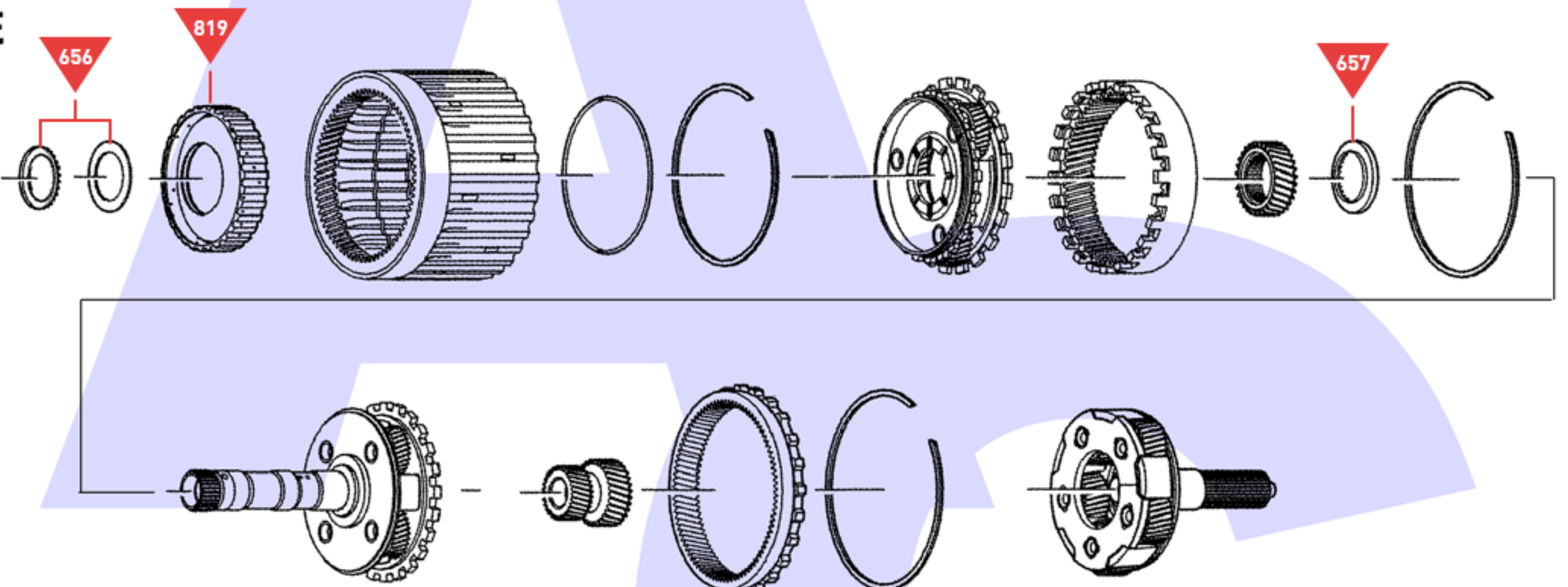

Planetary Assy's

F

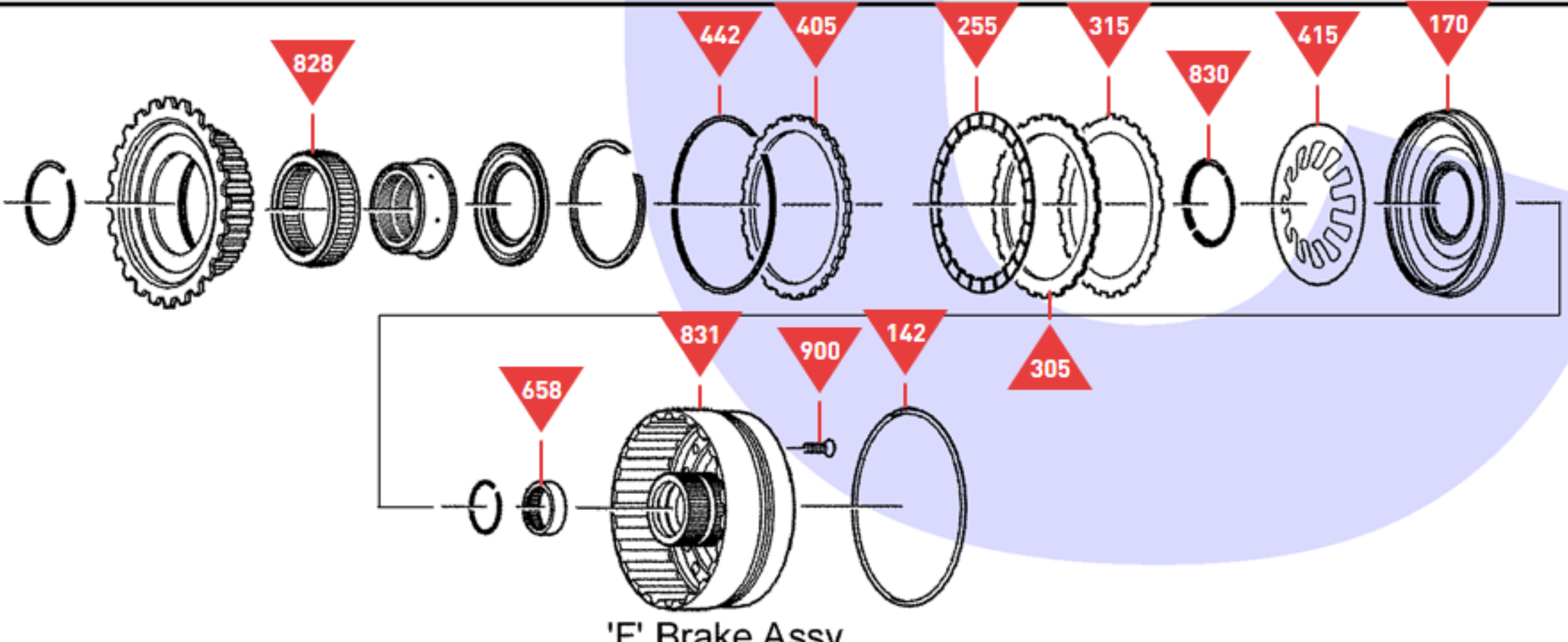

'F' Brake Assy

G

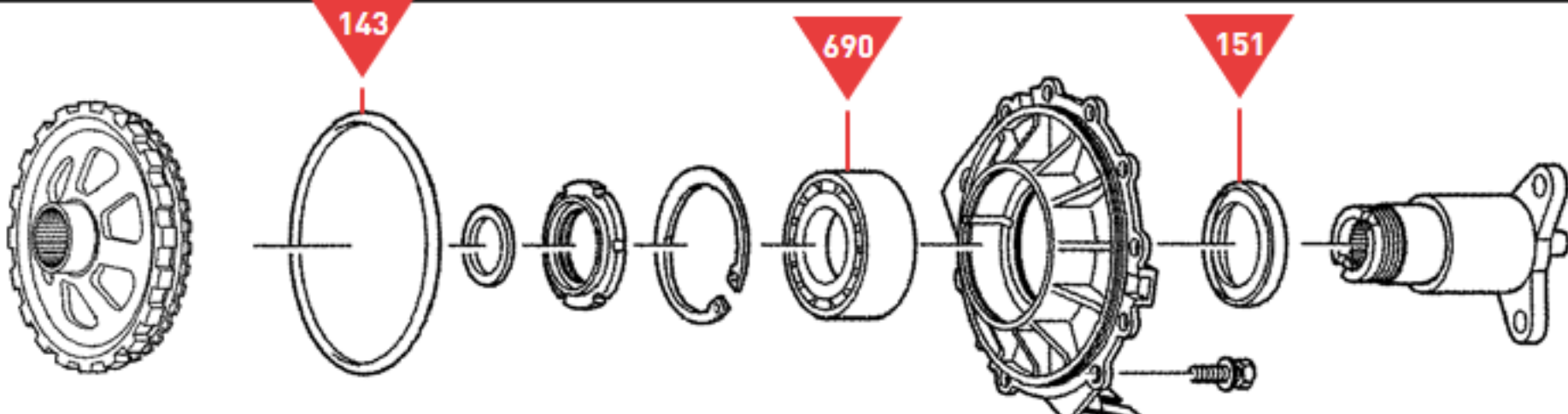

Park Lock & Output

H

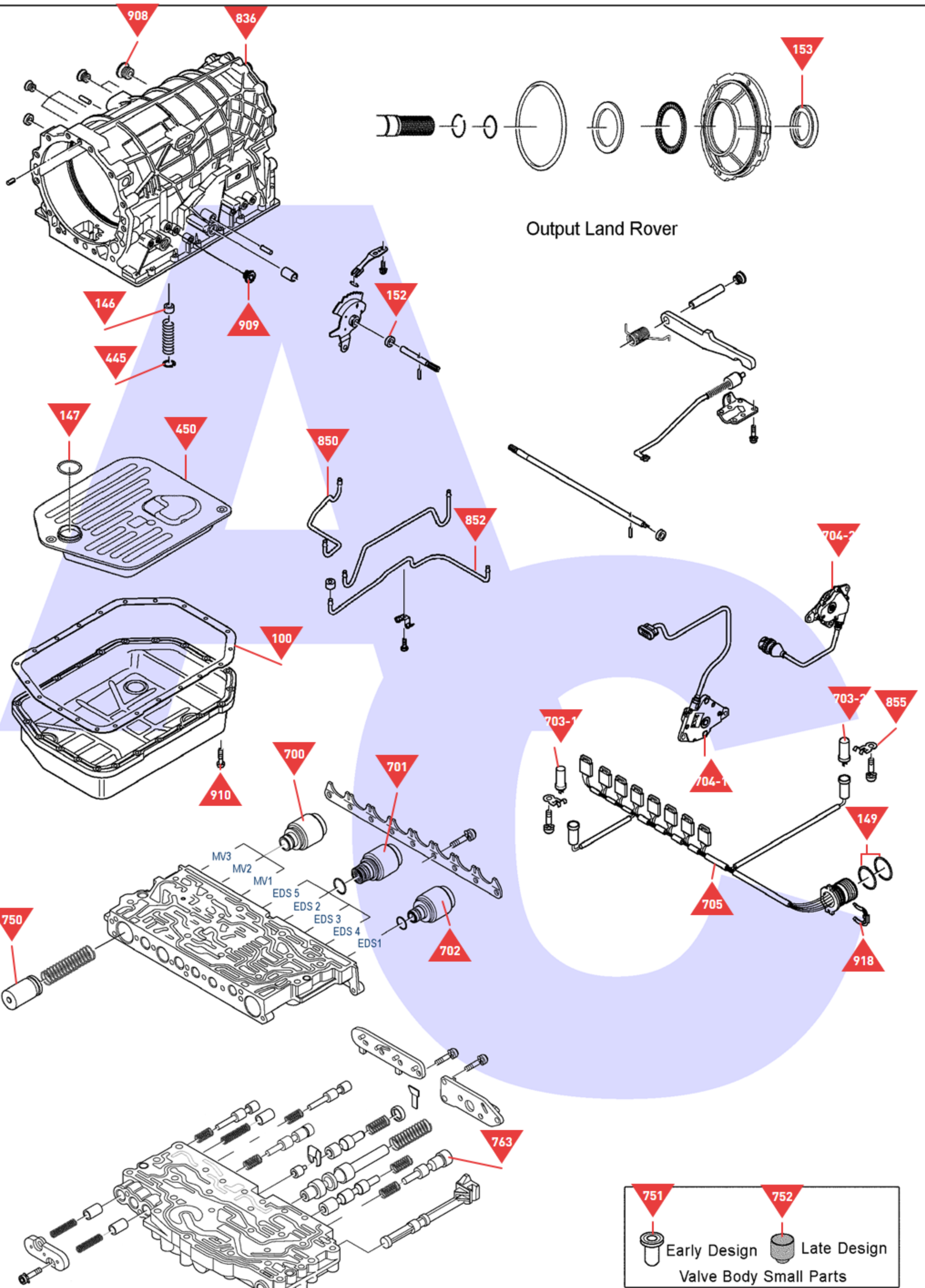

Park Mechanism, Oil Pan, Filter & Electrical Components